



**NOTIFICATION TO ATTEND MEETING OF THE SOUTH EAST AREA COMMITTEE
TO BE HELD IN THE COUNCIL CHAMBER, CITY HALL, DAME STREET, DUBLIN 2.,
ON MONDAY, 9 JANUARY 2017 AT 3.00 PM**

AGENDA

MONDAY, 9 JANUARY 2017

		PAGE
1	Presentation by Dublin Port on the Review of the Dublin Port Masterplan 2012 to 2040	
2	Minutes of South East Area Committee Meeting held on 12th December 2016	1 - 34
3	Environment and Transportation Department Matters	35 - 40
	i. Minutes of Traffic Advisory Group Meeting held on 20 th December 2016.	
	ii. 2017 Road Maintenance Services Works Programme.	
4	Planning and Property Management Department Matters	41 - 52
	i. Update on Poolbeg West SDZ.	
	ii. Report on proposed disposal of a property at Gloucester Street South / Moss Street / Bracken's Lane, Dublin 2.	
	iii. Report on proposed grant of a licence to manage the pavilion, tennis courts and padel courts, Bushy Park, Dublin 6.	
5	South East Area Matters	53 - 60
	i. Update on Environmental Services Unit, Housing Projects & Local Area Improvements and Sports and Recreation Section.	
	ii. Report on proposed extinguishment of public right of way Stable Lane.	
6	Motions	61 - 64
7	Questions to the Chief Executive 9th January 2017	65 - 72



MINUTES OF THE SOUTH EAST AREA COMMITTEE MEETING

HELD ON MONDAY, 12 DECEMBER 2016

- 1 Presentation on Temple Bar Public Realm Plan
Order: Noted.
- 2 Minutes of the South East Area Committee Meeting held on 14 November 2016
Order: Agreed.
- 3 Presentation on Proposed Part 8 Peace Park, Christchurch.
Order: Agreed to initiate the Part 8 Process.
- 4 **Environment and Transportation Department Matters**
 - i. Minutes of Traffic Advisory Group Meeting held on 29th November 2016.
Order: Noted.
 - ii. Update on the Part 8 Process for Drury Street Car Park.
Order: Agreed to recommend to city council.
- 5 **Planning and Property Development Department Matters**
 - i. Update on Poolbeg Strategic Development Zone (SDZ).
Order: Noted.
- 6 **South East Area Matters**
 - i. Update on Community Development Section, Environmental Services Unit, Housing Projects & Local Area Improvements and Sports and Recreation Section.
Order: Noted.
 - ii. Nomination of councillor to Aviva Project Monitoring Committee to replace Councillor Chris Andrews, who has resigned.
Order: Cllr. Dermot Lacey agreed to replace Cllr. Chris Andrews on foot of agreement reached at the October 2014 meeting of the South East Area Committee.
 - iii. Nomination of Vice-Chairperson of South East Area Joint Policing Committee (JPC) to replace former Councillor Jim O'Callaghan.
Order: Cllr. Frank Kennedy proposed and Cllr. Dermot Lacey seconded the nomination of Cllr. Claire O'Connor, which was agreed

by the committee.

- iv. Report on proposed Part 8 enhancement works at Herzog Park.
Order: Agreed to recommend to city council.

7 Motions

Motion 1 from Councillor Dermot Lacey

This committee requests the manager to remove the bin on Grantham Street specified in the email submitted with this motion to be removed once and for all.

Order: Report to councillor.

Motion 2 from Councillor Mary Freehill

Residents of Adrian Avenue are getting very smelly and foul tasting water following laying of pipes there some weeks ago. On checking it is asserted that the pipes for 17, 18, 19 and 20 Adrian Avenue are on private land, their pipes were not replaced but they are the only residents who have the problem with quality of water. Irish water installed meters on all of the above, so it looks as if Dublin City Council needs to immediately regularise the ownership of these pipes. Clearly it has been informally accepted that these services were in the public system until now. The residents are in a very difficult situation and left hanging between Drainage and Roads Departments.

Therefore this meeting agrees that the pipes for these houses are replaced and that the area be urgently taken in charge and that the quality of their water be brought up to standard. The attached photographs show that these houses are an integral part of Adrian Avenue.

Order: Report to councillor.

Motion 3 from Councillor Mary Freehill

Because of the high pedestrian and cycling traffic on Grove Road and Parnell Road that is poorly served by public lighting, in the interest of safety that these two roads are prioritised for white lighting.

Order: Agreed.

Motion 4 from Councillor Dermot Lacey

That this committee discusses the proposals to reduce residential parking on Creighton Street, Dublin 2 in advance of any action being taken by officials in relation to this matter and that the concerns and interests of the local community be paramount in any decisions relating to this and that the manager would report to this committee on any requests and actions that have been taken in relation to this issue in recent months.

Order: Agreed.

Motion 5 from Councillor Mary Freehill

Clareville Road, Shanid Road and Adrian Avenue have recently formed a residents' group. Recently on a walk about with them the following issues were raised.

1. Graffiti needs to be cleared from corner of Clareville Road and Kenilworth Park. The graffiti is mainly on utility services boxes. Also the name plates at either end of Clareville Road are badly disfigured and would benefit from repainting.

2. The state of Clareville Road and Adrian Avenue roads are very unsafe. The area that is tarred is uneven and the concrete part because it has subsided in parts has very dangerous lips measuring a few inches. This is extremely dangerous for cyclists and pedestrians crossing. There is a slight bend on Clareville Road beside Shanid Road which causes vehicles to move to other side of the road at that point, this need to be examined by Traffic Engineers. Traffic moves very fast outside rush hours, to slow it down a "children sign" might help at the school. It is agreed that Clareville Road which is a very busy artery and Adrian Avenue be listed for resurfacing in 2017.
3. Clareville Road is the main artery from Crumlin to Rathmines and is the route of No. 18 and 83 buses. The stop sign on Kenilworth Park turn causes very serious tail backs on this road especially from 8.00 am to 10.00 am on weekdays with Kenilworth Park having priority when they have the least of the through traffic. This needs to be re-examined by the Traffic Department and also to take into account that these two buses are the only west east public transport route, due to hold up at this corner travel time is severely lengthened.
4. ESB and telegraph wires are hanging across the road and they are quite low. In the interest of safety, ESB and Eir need to be contacted to ask them to move them underground.
5. There is a lane running at the rear of 74 - 78 Clareville Road. Because of heavy traffic, residents have to park in their rear garages. There is no public lighting on this lane which makes it very dangerous at night. The residents installed lights over their garages but they have been stolen. Therefore, it is agreed that public lighting be installed on the lane and that the council comment on possibility of "Taking in Charge" of this lane as a whole.
6. Double yellow lines (DYL) were agreed sometime ago for Clareville Road and corner of Adrian Avenue, the DYL were only installed on Clareville and not around the corner in Adrian, the result is that vans regularly park right at the corner making it very difficult for residents to safely egress this road.
7. There are two large junior schools on Clareville Road, parents dropping off their children in the mornings causes major problems for residents, in many instances, the lane mentioned in No. 5 and several drive ways are blocked because parents park and block their way. It is agreed that Dublin City Council engages with the principals of both schools to get them to put it to parents to agree a protocol of consideration for local residents. Furthermore, that we engage with Green School organisers in this regard.
8. That the local area committee agrees to meet the residents' association in January to discuss progress on the above points.

Order: Agreed.

Motion 6 from Councillor Frank Kennedy

Following a meeting at the NTA between local councillors and representatives of the NTA and Irish Rail 27th January, 2015, concerning the (then) proposed new Dart timetable and in particular the impact on level crossings, Irish Rail circulated a Q&A document about the level crossings to those councillors on 3 March 2015

(attached). Following consultation with local residents, the following observations have been made about this document:

1. Section 3 outlines 'How level crossings operate'. However, it only addresses the 'strike in' points for lowering the barriers and manual override to alleviate Rail congestion BUT does not mention the lifting of the barriers once the train & carriages have cleared the station & level crossing. There is an issue with the lifting of the gates at Sydney Parade where the lifting of the gates for northbound trains, which used to lift as soon as the train cleared the level crossing, have been extended by c.150 - 200 metres down the line towards the city. This creates an extra time delay which when multiplied by the number of northbound trains c.86 (173 movements per day table / 2 (50% each direction)) could be converted from closed into a safe useful operational time for the crossing - the train would be gone and not arriving. This becomes even more important if the service ever becomes more regular.
2. The gates at Sydney Parade Station close at the same time as Merrion Gates....i.e. when the train arrives in Booterstown Station. Is this really necessary? Safe alternatives must surely be possible?
3. This report only shows Data Tables for Closed Time at Sydney Parade so we do not have a comparison against a similar station (e.g. Lansdowne Road & platform is on the same side of the level crossing).
4. Are the closed times on the tables calculated based on actual time gates are closed for all stations or is it a simple calculation of number of trains by the expected standard closed time?. As we all know these can be very different measurements.
5. There is no international benchmarking of the closed times required for an electrified rail system (either lowering and raising of barriers) in this paper. The closure times here in Ireland seem to be considerably longer than the equivalent that apply internationally.

In light of these observations, this committee calls on Irish Rail and the NTA to review and internationally benchmark the lowering and raising of barrier times in the context of:

- (a) confirming the efficiency of current Dart Services, including the raising of the gates;
- (b) the current proposals re closing Merrion Gates; and
- (c) the possible increased provision of DART services (if this proposal continues to be under considerations)

Order: Agreed.

Motion 7 from Councillor Sonya Stapleton

This committee requests the manager to have a play area constructed for children in Mercer street flats.

Order: Report to councillor.

Motion 8 from Councillor Claire Byrne

That this area committee requests the area manager to carry out another traffic survey on St. Kevin's Road, Portobello. The last survey was carried out in August when school and commuter traffic is lower than usual and therefore the results

could not be reflective of the actual level of rat running and speeding that takes place on this street. In addition, can the area manager also confirm whether the planters that have been put in place as a traffic calming measure will remain as a permanent feature?

Order: Deferred.

Motion 9 from Councillor Claire Byrne

That this area committee calls on the area manager to address the on-going issue of illegal dumping and litter on South Dock Road as a matter of urgency. The residents have been in touch with Litter Enforcement and Fix My Street on a number of occasions but the problem has not yet been resolved.

Order: Deferred.

Motion 10 from Councillors Anne Feeney and Paddy Smyth

To ask the manager why the Carmelite Order in Terenure were granted an exemption for a 1.2 metre fence between the college grounds and the Rugby Club when it appears to contravene a number of planning clauses / rules for exemptions and to ask the manager to review the decision in light of new information.

Order: Report to councillor.

8 Questions to the Chief Executive

Order: Noted.

Chairperson

Monday, 12 December 2016

Attendance:

Members:

Claire O'Connor
Mary Freehill
Ruairi McGinley
Chris Andrews
Anne Feeney

Members:

Kieran Binchy
Frank Kennedy
Paddy Smyth
Patrick Costello

Members:

Mannix Flynn
Dermot Lacey
Sonya Stapleton
Paddy McCartan

Officers

Rose Kenny
Brian Hanney
Michael Noonan
Chris Adamson
John O'Hara

Fiona O'Brien
Gerry Geoghegan
Daibhi McDomhnaill
Rossana Camargo
Mark Ginnetty

Jennifer Wall
Eileen Martin
Peter Leonard
Myles Farrell

Apologies:

Cllr. Claire Byrne

Q.1 Councillor Ruairí McGinley

To ask manager to confirm that footpath renewal works are included in 2017 works programme.

Reply:

Road Maintenance Services' 2017 Works Programme includes footpath renewal works; locations are currently being considered.

Q.2 Councillor Ruairí McGinley

To ask the manager to reinstate the double yellow lines on *details supplied.

Reply:

The double yellow lines on the south side of *details supplied have been referred for renewal.

Q.3 Councillor Ruairí McGinley

To ask the manager to (details supplied).

Reply:

We have examined the public lighting columns here and have added 20 columns to our painting list for inclusion in a future painting programme, subject to finances made available.

Q.4 Councillor Ruairí McGinley

To ask the manager to have road maintenance works carried out on Clareville Road, Harold's Cross (photo evidence of need for works attached).

Reply:

Remedial works on Clareville Road will be put on Road Maintenance Services' Works List.

Q.5 Councillor Ruairí McGinley

To ask the manager to plant trees on (details supplied).

Reply:

Parks and Landscape Services have added trees on *details supplied over the past number of years and there are now 16 trees here. The spaces without trees are unfortunately not suitable for planting due to the presence of both over and underground services.

Q.6 Councillor Paddy Smyth

To ask the manager to ensure that the large commercial bins that are permanently blocking the footpath outside 47-48 Chelmsford Road (see photo attached) are moved by the relevant business owner to a more appropriate location.

Reply:

Following a visit from the South East Area Litter Warden, the owners of the premises, who were responsible for the Euro bins (Brown Sugar Hairdressing), have removed same and reverted to a bag collection system.

Q.7 Councillor Paddy McCartan

Could the manager arrange to have planters and / or a strip of Magnolia trees planted in and around the circular area at the junction of Park Avenue and Gilford Road, Sandymount? This area has become bereft of shrubbery due to the recent removal of trees.

Reply:

Trees have not been removed from this junction by Park Services. There are currently a number street trees (*Carpinus* spp.) planted at the location and this is considered sufficient for this location.

Q.8 Councillor Paddy Smyth

To ask the manager to have double yellow lines (DYLs) painted at the areas of dished pavement on Larkfield Grove (see photo attached). Cars are regularly parking at same, potentially blocking access for emergency vehicles.

Reply:

The request for double yellow lines on Larkfield Grove at the two areas of dished pavement is still listed on the Traffic Advisory Group agenda for examination and report. The councillor will be informed of the recommendation in due course.

Q.9 Councillor Ruairí McGinley

To ask the manager to increase bike parking facilities in Kimmage Village close to Supervalu

Reply:

Kimmage Village will be assessed for its suitability for cycle stand installation and will be included on next year's work programme, should the criteria be met. The councillor will be informed in due course.

Q.10 Councillor Dermot Lacey

To ask the manager if she will contact Dublin Bus with a view to improving safety at this bus stop as outlined in the email submitted with this question.

Reply:

The mini pillar position is consistent with Dublin Bus practices and the roll out of previous RTP1 installation schemes. Similar positioning of other street furniture is common place throughout the city centre.

Q.11 Councillor Mary Freehill

17 Grosvenor Road, Rathmines (St. Michael's House School) is a period house and I request that it be added to the register of protected structures.

Reply:

The building at No. 17 Grosvenor Road, Dublin 6, is situated in an area zoned Objective Z2 "to protect and/or improve the amenities of residential conservation areas" in the Dublin City Development Plan 2016 - 2022, which came in force on the 21st October 2016. The building is not on the Record of Protected Structures (RPS).

Policy CHC4 and Sections 11.1.5.4 and 11.1.5.6 of this (new) Development Plan in relation to all of the city's conservation areas, including the Z2 'residential conservation areas', provides a development management framework to ensure that development complements the character of the area, complies with development standards and takes the opportunity to protect and enhance the character and

appearance of the area and its setting; see Chapter 11 of the Dublin City Development Plan 2016-2022 Written Statement Volume 1 (interim publication) at: <http://www.dublincity.ie/main-menu-services-planning-city-development-plan/dublin-city-development-plan-2016-2022>

This is considered to be an adequate level of protection of the amenities of this Z2 'residential conservation area' for the present.

The National Inventory of Architectural Heritage (NIAH) is currently undertaking a comprehensive survey of Dublin City, which informs the Minister for Arts, Heritage, Regional, Rural and Gaeltacht Affairs, in the making recommendations to the City Council for the addition of structures to the City's Record of Protected Structures.

Given that the City already has a Record of Protected Structures (RPS) with, in excess of 8,500 entries, it is considered both prudent and good practice to await any recommendation regarding proposed additions to the RPS, including No. 17 Grosvenor Road, Dublin 6, to be made by the NIAH, arising from its current survey of Dublin City, including the formal recommendation to be made by the Minister. This is also relevant, given the legal and other liabilities of owner(s) and occupier(s) of a structure where it is added to the RPS.

The assessment of additions to (or indeed deletions from) the Record of Protected Structures is intended to commence in 2017, in association with:

- the consideration of recommendations for additions to the RPS published by the NIAH/Ministerial Recommendation, and
- the sequential surveying of 10 priority areas to be considered for potential designation as an Architectural Conservation Area (ACA) in the Dublin City Development Plan 2016 - 2022, which came into effect on the 21st October 2016.

A file for the proposed addition of No. 17 Grosvenor Road, Dublin 6 has been opened and added to the list of candidate additions to the RPS to await consideration in the future.

Q.12 Councillor Kieran Binchy

To ask the manager to clear and clean the Beaver row footpath (Dodder side) which is being obstructed by overgrown shrubbery and build up of leaves.

Reply:

Waste Management Services had the footpath cleaned and the leaves removed at the above mentioned location on the 30th November 2016.

Parks Services will undertake a clearance of vegetation along the bank of the River Dodder at Beaver Row. The work will be added to our works programme and undertaken over the coming four to six weeks.

Q.13 Councillor Kieran Binchy

To ask the manager to clean and clear of leaves the footpaths on the exterior of Fitzwilliam Square (the footpaths between the houses and the road), in particular the footpath outside and around No. 28 Fitzwilliam Square.

Reply:

Waste Management Services had the leaves removed from the above mentioned location on the 28th November 2016.

Q.14 Councillor Anne Feeney

To ask the manager, to schedule the resurfacing of Fortfield Road and replace the badly deteriorated traffic ramps which are causing damage to car and bicycle tyres on this busy commuter road which forms the boundary with South Dublin Council area. In addition, lighting on the road needs to be improved.

Reply:

We will investigate the existing lighting here, and any necessary improvements will be added to a list for inclusion in a future public lighting programme of improvements, subject to finances made available.

The ramps on Fortfield Road are due to be resurfaced in early 2017.

Q.15 Councillor Anne Feeney

To ask the manager when exactly will a pedestrian solution be put in place for the junction of Highfield Road and Rathgar Road (Rathgar village) as this is an extremely dangerous crossing for all, but particularly for older people.

Reply:

There is no proposal to provide a pedestrian crossing at the junction of Highfield Road and Rathgar Road. During public consultation as part of the Rathgar Village Improvement Plan (VIP) the provision of a pedestrian crossing between Bijou Restaurant (at corner of Orwell Road / Rathgar Road) and the 108 Pub (Rathgar Avenue) was identified as a high priority goal for the village. The contract for the pedestrian crossing has now been awarded and works are due to commence in early 2017.

The Traffic Advisory Group, at its meeting of 18th August, 2015, did not recommend traffic calming at the junction of Highfield Road and Rathgar Road as this area is already calmed due to its layout and proximity to the traffic signals in Rathgar Village. An examination of accident statistics shows that there has not been an accident at this junction in over eight years. This department is focusing on improving the neighbouring signalised junction at present. The Traffic Advisory Group, also, did not recommend traffic signals at the junction of Highfield Road and Rathgar Road as this junction operates satisfactorily with road markings and regulatory signage.

At its meeting of 25th October, 2016, the Traffic Advisory Group did not recommend to relocate the existing pedestrian crossing on Highfield Road near to the junction with Rathgar Road as it was installed to serve the needs of the local community.

The contractor is due to begin works on the pedestrian crossing at Rathgar Road / Orwell Road in mid-January 2017.

Q.16 Councillor Anne Feeney

To ask the manager to consider an alternative traffic light solution for the tip of Harold's Cross Park where the road splits on the left to Harold's Cross village and on the right towards Mount Argus. Currently there is a traffic light directly in front of the Celtic Cross, making it difficult to see this Historic and symbolic Cross of the park and Area. If a solution cannot be found for the traffic lights, can one be suggested for elevating the Cross itself?

Reply:

The Intelligent Traffic System (ITS) Section of Dublin City Council intends undertaking a safety evaluation regarding the current placement of the traffic signals at Harold's Cross Park and will report back once this process is complete.

Q.17 Councillor Anne Feeney

To ask the manager to investigate the safety and protrusion of some trees on St. Kevin's Park, Dartry and prune them where necessary.

Reply:

The street trees at St. Kevin's Park, Dartry have been included in our street tree programme for 2017. It is proposed that the trees will be pruned in 2017 as part of this works programme.

Q.18 Councillor Anne Feeney

To ask the manager to enforce any parking restrictions as part of Planning Application 3963/15. Currently illegal parking relating to the development work is causing a great deal of inconvenience and annoyance for local residents.

Reply:

The council's parking enforcement contractor, Dublin Street Parking Services (DSPS), will be requested to monitor the location and take any enforcement action possible. Residents should also be encouraged report illegal parking directly to DSPS at: info@dsps.ie or tel.: 6022 500.

Planning permission for the named development was granted by An Bord Pleanála on 30 May 2016. There are no conditions in the permission relating to parking during the course of development works.

Q.19 Councillor Anne Feeney

To ask the manager to investigate the feasibility of a yellow traffic box at the Luas station traffic lights in Ranelagh, on the side of the road leading from the Canal and directly outside the access gate to Ranelagh Close residences. Currently cars emerging from Ranelagh Close have a blind spot, given cars can park directly to the right and it can be very difficult to exit onto the main road for residents and visitors.

Reply:

The request for a yellow box on Ranelagh Road outside the access gate to Ranelagh Close, has been referred to the Traffic Advisory Group for examination and report. The councillor will be informed of the recommendation in due course.

Q.20 Councillor Claire O'Connor

Can the manager arrange for a Housing Maintenance representative to replace the bathroom tiles in *details supplied?

Reply:

Following inspection, the Area Maintenance Officer reports that the vinyl tiles in the bathroom do not need to be replaced.

Q.21 Councillor Claire O'Connor

Can the trees located outside details supplied be cut down in circumstances where their roots have damaged garden walls and lawns?

Reply:

The street trees outside the above mentioned locations have been inspected recently. While evidence of cracking on one of the garden walls was present, there was no reason to believe that this damage resulted from the street tree.

Therefore, it is not proposed to have the trees felled as requested.

Q.22 Councillor Claire O'Connor
Can extra bins be made available in Mount Argus Park?

Reply:

Clarification was sought from the councillor. The matter will be considered on receipt of the clarification.

Q.23 Councillor Claire O'Connor
Can Casimir Road be cleaned?

Reply:

Waste Management Services had Casimir Road cleaned on the 30th November 2016.

Q.24 Councillor Claire O'Connor
Can the double yellow lines on Garville Lane be extended to the front of both 69 and 71 Garville Lane?

Reply:

The request to extend the double yellow lines on Garville Lane between 69 and 71 has been referred to the Traffic Advisory Group for examination and report. The councillor will be informed of the recommendation in due course.

Q.25 Councillor Claire O'Connor
Can the manager put a pedestrian traffic light at the junction of Cowper Road and Upper Rathmines Road?

Reply:

The Traffic Advisory Group, at its meeting of 23rd August, 2016, reported that following a site inspection, it is deemed that there is not enough demand or difficulty in crossing to warrant the installation of a pedestrian crossing at the junction of Rathmines Road Upper and Cowper Road. A pedestrian crossing, therefore, was not recommended. This position was supported by the Intelligent Transport System Section of the Environment and Transportation Department, who reviewed the site also and did not find a need for a pedestrian crossing at this location.

Q.26 Councillor Claire O'Connor
Can the undergrowth be cleared from 94 Merton Drive down to Sandford Square apartments?

Reply:

Waste Management Services had the above mentioned location cleaned on the 29th November 2016.

This refers to a small amount of growth protruding from a private property and the occupier has been contacted requesting them to cut back this area.

Q.27 Councillor Claire O'Connor
Can lighting be provided at junction of Merton Drive and Sandford Square?

Reply:

We will investigate the existing lighting here, and any necessary improvements will be considered for inclusion in a future public lighting programme of improvements, subject to finances made available.

Q.28 Councillor Claire O'Connor

Can the manager arrange for Temple Road to be resurfaced in circumstances where it is full of broken up and rutted tarmac and contains many potholes?

Reply:

Temple Road will be considered for resurfacing as part of the 2017 Road Maintenance Services' Works Programme.

Q.29 Councillor Claire O'Connor

Can the manager arrange for speed ramps to be placed at the three corners of South Hill?

Reply:

The Traffic Advisory Group at its meeting of 25th February, 2014, had reported that it is not recommended to provide speed ramps on South Hill as the roads are less than 200 metres, which does not meet the criteria for the provision of such traffic calming measures.

The criteria used to determine the need for traffic calming measures are as follows:

- The road should have a straight run of approximately 200 metres.
- The 85th percentile speed (speed exceeded by 15% of vehicles) should exceed 50km/h.
- Traffic volumes should exceed 60 vehicles per hour.
- There should be genuine road safety concerns based on accident statistics or observed road safety patterns or a written report from an Inspector in the Garda Traffic Division, Dublin Castle, relating to an issue of safety.

Q.30 Councillor Claire O'Connor

Can a light be put on Kenilworth Park at the Kimmage Road Lower end where the section with no houses is dark?

Reply:

There is no requirement for additional lighting at this location. However, the existing low pressure sodium (orange colour) lighting along this road will be replaced with LED (white) lighting as part of our LED replacement programme.

Q.31 Councillor Mannix Flynn

Can the manager issue a report regarding Crampton Buildings, how many of the units are occupied? How many former tenants came back? How many new tenants? How many units are vacant, if any? What is the proposed ceremony opening date?

Reply:

The total number of units is 28 and all units have been allocated. One unit needs disabled adaptations. Nine former residents returned. No date has been organised yet for the opening ceremony.

Q.32 Councillor Mannix Flynn

Can the area manager confirm that the Milltown Bottle bank car park will not be used for the disposal of Christmas Trees this year?

Reply:

Dublin City Council will not be using Milltown Car Park as a designated collection point for Christmas trees.

The full list of collection sites and waste management arrangements for Christmas are also attached.

Q.33 Councillor Mannix Flynn

Can the manager issue a full report and update with regards the Dubline project? This report to include all expenditures to date and grants, and also all of those that refused to take up the offer of funding from the Dubline project over the past number of years.

Reply:

The status and expenditure to date of the Dubline projects is outlined in Table 1 below while details relating to offers of funding are contained in Table 2.

Table 1

Project	Expenditure to date	Project Status
Interpretative Panels	€195,413.60	Phase 1 completed December 2015.
Wayfinding	€87,042.36	Completed December 2015.
Banners	€16,373.76	96 banners along with Palace Street building banner installed November 2016.
Love the Lanes Phase 1	€92,587.00	Complete.
Love the Lanes Phase 2	€12,042.35	Ongoing.
City Wall Lighting Upgrade	€63,356.40	Completed February 2016.
Thomas Street Historic Lighting	€81,581.08	Ongoing.
Thomas Street/James Street Planters	€76,338.31	Complete.
Nicholas Street	€55,867.33	Completed April 2016.
Crane Street	€8,477.16	Part VIII approved by City Council. Works to start in January 2017.
Street Planters	€162,325.04	68 planters installed on High Street/Thomas Street.
Peace Park	€13,923.60	Part VII deferred until December Area Committee Meeting.
Castle Street	€47,594.20	Pre Part VIII noted at November Area Committee Meeting.
Lamp post crest repainting	€31,371.40	Completed June 2016.
St. Audeon's Park	€26,227.30	Tender documents to issue shortly

Table 2

Project Name	Applicant	Grant Amount €	Status	Grant Paid to date €
Irish Whiskey Museum	Extreme Ireland	150,000	Project Complete.	150,000
The Learning Space	St. Patrick's Cathedral	152,650	Project Complete.	152,644
Smock Alley Tours	Smock Alley Theatre	17,824	Project Complete.	16,420
Dublinia 2014	The Medieval Trust	184,000	Project Complete.	184,000
Redevelopment of St. Werburgh's Church	St. Werburgh's Church	200,000	Not going ahead.	0
Christ Church Cathedral	Christ Church Cathedral	188,550	On hold.	0
Tailors Hall	An Taisce	29,040	On hold.	0
Dublne Bike Tour	Dublin City Bike Tours	33,200	Ongoing - project will be complete in Feb 2017.	0

Q.34 Councillor Mannix Flynn

Can the manager confirm whether the Staircase Hostel, which is now a home for asylum seekers, is to be converted into a homeless shelter or emergency homeless accommodation?

Reply:

The Staircase Hostel, 20 - 21 Aungier Street, Dublin 2 is privately owned and run. We have no plans to use this hostel.

Q.35 Councillor Mannix Flynn

Can the manager issue a full report with regards the vacant site on Fishamble Street owned by Dublin City Council? This site was ear marked for the Dublin House project, however it was recently announced that this site is now going to be used for 6 rapid build apartments. Can this report also include whether these rapid build apartments will be emergency accommodation or whether they will facilitate those on our housing list?

Reply:

The vacant site at Fishamble Street site is included in Dublin City Council's Social Housing Programme. When the development is completed the dwellings will be let as per the council's Scheme of Letting Priorities.

Q.36 Councillor Mannix Flynn

Can the manager issue a full list of all premises in the SEA that have been given a street furniture licence? This report also to include a full account on how much money this scheme has generated to date. How many have defaulted, if any, on payments? Is there outstanding debt to be collected and how many enforcement proceedings have been taken against premises that have illegal street furniture on the streets?

Reply:**Premises that have been given a street furniture licence**

1.	1	3FE	32-34	Lower Grand Canal Street
2.		Al's Stage Door (Ex Lemon Jelly)	10B/11	Essex Street East
3.		Ann's Bakery	26	Earl St North
4.		Bach 16 (Ex D'Vine Wine)	16	Bachelor's Walk
5.		Bad Ass Cafe	9-11	Crown Alley
6.		Balfes formerly Café Novo		The Westbury, Balfe Street
7.		Ballsbridge Deli	6	Merrion Road
8.		Base woodfired Pizza	18	Merrion Road Ballsbridge
9.		Bewley's at Arnotts	97-107	Middle Abbey Street
10.		Bijou Deli	49	Highfield Road
11.		Bleeding Horse Public House.	24/25	Camden Street Upper
12.		BóBó's	50 - 51	Dame Street
13.		Bruxelles	7-8	Harry Street
14.		Bunsen	3	South Anne Street
15.		Burritos and Blues	2	Wexford Street
16.		Busyfeet & Coco	41 - 42	South William Street
17.		Butler's Chocolate Cafe	4	Liffey Street Lower
18.		Butler's Chocolate Café	9	Chatham Street
19.		Butlers Chocolate Cafe (Ranelagh)	61	Ranelagh
20.		Butlers Chocolate Café Wicklow St	24	Wicklow Street
21.		Cafe Boulevard	132	Lower Baggot Street
22.		Café Crema	84	Middle Abbey Street
23.		Café Sol Hatch Street	33	Lower Hatch Street
24.		Café Vivaldi	4	Temple Bar Square
25.		Caffe Nero	88	Donnybrook Road
26.		Caffe Noto	79	Thomas Street
27.		Calzone	63	South William Street
28.		Carluccios	52	Dawson Street
29.		Chez Max	1	Palace Street
30.		Cinnamon Cafe Smithfield		Coke Lane, Smithfield
31.		Coffee Addiction	342	North Circular Road,
32.		Coffee Angel	15	South Leinster Street,
33.		Coffee Nation	64	Mary Street
34.		Copán	304	Lower Rathmines Road
35.		Coppinger Row	1	Coppinger Row
36.		Davy Byrne's	21	Duke Street
37.		Decwells	60	South Great. George's Street
38.		Deli-Licious	3	Lisle Rd
39.		Dolce Vita	5	Cow's Lane, Temple Bar
40.		Eddie Rockets	7	South Anne Street
41.		Expert Hardware Donnybrook	11	The Mall

42.	Fade St Social	4-7	Fade Street
43.	Fitto	22	Bachelors Walk
44.	Fitzgerald's Public House,	22	Aston Quay
45.	Four Star Pizza,	51	Shelbourne Road,
46.	GBK Temple Bar	1	Temple Bar Square
47.	Gotham Cafe Ltd	8	South Anne Street
48.	Gourmet Burger Kitchen (Castlemarket)		Castle Market,
49.	Gourmet Burger Kitchen	5	South Anne Street
50.	Grand Central Bar	10/11	Lower O'Connell Street
51.	Grogan's Castle Lounge	15	South William St./Castle Market
52.	Harry's on the Green	2	South King Street
53.	Hippety's Ltd.,	11	Sprangers Yard, Cecelia Street,
54.	Hobart's Restaurant	55	Ranelagh
55.	Hogan's/ L'Geuleton Restaurant	1-3	Fade Street
56.	Il Fornaio	1	Liffey Street Lower
57.	Insomnia	4	Harcourt Hall, Charlotte Way,
58.	Insomnia	8	Merrion Road
59.	Insomnia	20	Liffey Street Upper
60.	Insomnia Chatham Row	2	Chatham Row
61.	Insomnia Coffee Company IFSC	IFSC	Mayor Street
62.	Its a Bagel (Arnotts)	97-107	Abbey Street Middle
63.	J.W. Sweetman	1-2	Burgh Quay
64.	Javaholics Coffee Co.,	1	Merville Avenue, Fairview
65.	Jo'Burger (Ex Bedlam)	4 - 5	Castle Market
66.	Joe's Cafe Arnott's		Liffey Street Upper
67.	KC Peaches Pearse St	Unit 10A	Pearse Street
68.	KC Peaches Stephen's Green	35-37	Saint Stephen's Green
69.	Kehoes Bar	9	South Anne Street
70.	Kinara Restaurant Ltd.,	17	Ranelagh
71.	La Maison	15	Castle Market
72.	La Pizza,	14A- 15	O'Connell Street Upper
73.	La Reserve Brasserie	53	Ranelagh Village
74.	Langkawi	46	Baggot Street Upper
75.	Le Phare	10	Lower Abbey Street
76.	Leeson Lounge	148	Leeson Street Upper
77.	Lemon Crepe & Coffee Company, (2)	66	South William Street
78.	Londis		O'Connell St
79.	Madigan's Bar	25	North Earl Street
80.	Madigan's Bar	19	O'Connell Street Upper
81.	Mao Restaurant	2-3	Chatham Row

82.	Mario's Restaurant	39	Ranelagh
83.	Mary's Bar	6 - 8	Wicklow Street
84.	McDaid's Pub	3	Harry St
85.	Metro Cafe,	1A	Chatham Row
86.	Miller's Restaurant	50	Upper Baggot Street
87.	Mr Middleton Garden Shop	58	Mary Street
88.	Munchies	33-34	Sir John Rogerson's Quay
89.	Murray's Bar	33 - 34	O'Connell Street Upper
90.	Neary's Public House	1	Chatham Street
91.	O'Donovan's Shop	44	Pearse Street
92.	Oliver Saint John Gogarty		Anglesea Street, Temple Bar
93.	O'Shea's Irish Restaurant,	23	Anglesea Street
94.	Osteria Lucio		The Malting Tower, Grand Canal Quay
95.	O'Sullivan's Bar	10	Westmoreland Street
96.	Pablo Picante	4	Clarendon Market
97.	Paddy Cullens & Mary Mac's	12-14	Merrion road
98.	Panem	21	Ormond Quay
99.	Pasta Fresca	2-4	Chatham Street
100.	Peters Pub,	1	Johnson Place
101.	Petit Café	35A	Kildare Street
102.	Pygmalion	16/18	South William Street
103.	Queen of Tarts		Cows Lane, Temple Bar
104.	Ramblers Way	57-58	Mary Street
105.	River Bar		D'Olier Street
106.	Rushs Bar	65	South William Street
107.	Rustic Stone	17	South Great Georges St
108.	Saba	22	Baggot St Upper
109.	Saburritos	3	North Earl Street
110.	Salamanca (Private Landing Here)	1	Saint Andrew St
111.	Sandymount House	1	Sandymount Green
112.	Searsons	42-44	Baggot Street Upper
113.	Simon's Place	22	South Great Georges Street
114.	Sinnott's Bar		South King Street
115.	Spar Ranelagh	29	Ranelagh Road
116.	Spar Patrick St	51-53	Patrick Street
117.	Spar Talbot St	70-72	Talbot Street
118.	Starbucks Coffee Shop	1	Riada House College Green
119.	Steps of Rome	1	Chatham Street
120.	Subway	55	Shelbourne Rd
121.	Taste Food Co (Ex Kaffe Moka)	39-40	South William Street
122.	Temple Bar Hotel / Buskers	13-17	Fleet Street
123.	Thai Style	2	Earl Street North
124.	The Auld Dubliner	24 - 25	Temple Bar Street

125.	The Bagel Factory (Harcourt Rd)	16	Harcourt Road
126.	The Bagel Factory (Leeson St)	103a	Leeson Street Lower
127.	The Bailey,	2-4	Duke Street
128.	The Barge Inn	42	Charlemont Street
129.	The Bridge 1859	13	Ballsbridge Tce.
130.	The Bull and Castle Inn	5-7	Lord Edward Street,
131.	The Button Factory		Curved Street
132.	The Cappucino Bar	10	Sprangers Yard, Cecilia Street
133.	The Duke Public House	9-10	Duke Street
134.	The Farm Restaurant	133	Leeson Street Upper
135.	The French Paradox	53	Shelbourne Road, Ballsbridge
136.	The Gin Palace	42	Middle Abbey Street
137.	The Grand Social	35	Liffey Street Lower
138.	The Greenery	3	Eirpage House, Donnybrook Road
139.	The Loft	38A	Drumcondra Road Upper
140.	The Lotts	9	Liffey Street Lower
141.	The Port House	64	South William Street
142.	The Rathgar Public House	108	Rathgar Road
143.	The Roasted Bean Coffee Co	53	Talbot Street
144.	The Shack	24	Essex Street East
145.	The Sweetest Thing	17	Bachelor's Walk
146.	The Woollen Mills (The Winding Stair)	41-42	Ormond Quay Lr.
147.	The Woolshed Baa and Grill Ltd	Unit 4	Parnell Centre, Parnell Street
148.	Third Space	Block C	Smithfield
149.	Chopped	8/9	Westmoreland Street
150.	Tolteca	38	Baggot Street Upper
151.	Tolteca Camden St.	40	Camden Street Lower
152.	Tribeca Ltd	65	Ranelagh
153.	Turks Head,	27	Parliament Street
154.	Vintage Bar	7	Camden Street Lower
155.	Waterloo Public House	36	Baggot Street Upper
156.	Whitefriar Grill	16	Aungier Street
157.	Wigwam	54	Middle Abbey Street
158.	Woodstock	156	Phibsborough Road

Income to November 31st: €492,529.50. A zoning map and pricing structure is attached.

A number of premises are behind in renewing their licence, this is not unusual, and most renew within a month or two of their renewal date.

46 Enforcement Notices were issued for unlicensed furniture on the public footpaths

Q.37 Councillor Mannix Flynn

Can the manager ensure that every single resident in Nicolas Street and Christchurch apartments and all the business in the surrounding area of the Peace Park of Christchurch are fully informed of the intended plans of the refurbishment of the Peace Park?

Reply:

The plans for the refurbishment of Peace Garden will go through the full Part 8 planning procedure which in itself is a public consultation and all plans will be on public display in Civic Offices, Wood Quay for the required period of time.

To date the design team has meet with the Jury's Inn management and the Christchurch View Apartments residents' committee representatives, both of which adjoin the park.

A leaflet drop will take place to further inform residents in the surrounding areas of the Peace Garden proposals and associated Part 8 procedures.

Q.38 Councillor Mannix Flynn

Can the manager issue a full report as to how many hostels, homeless emergency services and emergency accommodation units are in the SEA? This report also to include such services as drug services, needle exchange or methadone clinics.

Reply:

The tables below list the following services:

1. Homeless Emergency Accommodation Services.
2. Day Services.
3. Addiction and Rehabilitation Services.

Project Type	Project Name	POSTAL CODE	LA	Capacity	Target group	DCC Area
STA	DePaul - Peters Place	D8	DCC	35	M,W	South East Area
STA	PMVT - DCC -	D2	DCC	36	M,W,C	South East Area
STA	PMVT - DCC -	D8	DCC	20	M	South East Area
STA	PMVT - DCC	D1	DCC	36	M,W	South East Area
STA	PMVT - DCC	D2	DCC	18	M	South East Area
ONO	PMVT - ONO	D2	DCC	20	M	South East Area
STA	S. Army - STA	D2	DCC	30	M	South East Area
STA	Simon - Emergency Shelter	D2	DCC	30	M, W, C	South East Area
PEA	Oakley House	D6	DCC	14	M	South East Area
PEA	Clanbrassil	D8	DCC	18	W, C	South East Area/South Central
PEA	Clonskeagh	D6	DCC	16	W, F,	South East Area/DLRD

M=Men, W=Women, C= Children.

Day Services			
No.	Name	Type	Location
1.	Merchants Quay Day and Night Service	Day Support and Information Service	Dublin 8

Addiction and rehabilitation services are funded by the HSE with DCC supporting costs for the premises wherein the services are located.

Addiction and Rehabilitation Services				
No.	Name		Location	Total on 23rd September 2016
1.	Merchants Quay Ireland (Night Service)		Dublin 8	65
2.	Dublin Simon Addiction Services		Dublin 8	30

Q.39 Councillor Mannix Flynn

Can the manager fast track the removal of the phone boxes on Lord Edward Street and also the phone boxes on Lower Kevin Street. These set of phone boxes are commonly used for drug taking and drug selling. They are also sites of anti social behaviour and they are hardly ever used by members of the public. They have become an issue for local residents and business.

Reply:

See below synopsis of response received from EIR in relation to this question:

The kiosk on Lord Edward Street has been noted for recovery and the Road Opening Licence submitted on foot of a direct request by TUSLA the child protection agency. The kiosk is directly outside their entrance so Eir agreed to their request.

There are no kiosks on Kevin Street but there is a double kiosk at each end:

- One on Cuffe Street – under consideration as it is on Dublin City Council’s list for removal.
- One on New Bride Street - neither An Garda Síochána nor Dublin City Council has requested the recovery of this kiosk so it is not even under consideration for removal at this point in time. The payphone exceeded ComReg’s recovery threshold so was not selected in the latest round of national recoveries.

The unit on Bride Street will be monitored over the next few months and if there is found to be regular anti-social behaviour here, it will be recommended for removal.

Q.40 Councillor Mannix Flynn

Can the manager issue a full report on any plans for the New Years Eve festival (NYF)? That report to include how much financial assistance Dublin City Council

gives the festival. Where this money is spent. What representatives, if any, sit on the board of NYF?

Reply:

This year's New Year's Festival includes a three-day (30th December – 1st January) citywide programme of events including the New Year's Eve Countdown Concert at St. Stephens Green South, "Sky Dance at the Custom House" - a spectacular aerial outdoor performance by Fidget Feet, Luminosity 3D animations at the Custom House, a free New Year's Day Concert at St. Stephen's Green, along with other free events throughout the city as part of an arts focused programme. Further information in relation to the full programme can be found at www.nyfdublin.com.

A three year memorandum of agreement was reached with Fáilte Ireland in 2014, covering the period 2014 – 2017. This committed an annual contribution of €100,000 by Dublin City Council towards the costs of running the festival, which is led by Fáilte Ireland. In 2016, it was agreed that a more comprehensive arts programme would be developed to complement the festival, at an additional cost of €100,000, to be divided equally between Fáilte Ireland and Dublin City Council.

Dublin City Council's Events Unit and Arts Office are represented on a New Year's Festival Steering Group, which meets regularly to oversee and monitor the delivery of the festival.

Q.41 Councillor Mannix Flynn

Can the area manager initiate the process to have a plaque placed on the wall of the Bailey Bar to honour Mr. John Ryan? John Ryan was a significant literary figure in the 1940's and 1950's Dublin. He was founder of "Envoy Magazine" and was widely regarded as having championed the likes of Brendan Behan, JP Dunleavy and Kavanagh.

He was a former owner of the Bailey public house and in 1954 organised the first Blooms Day commemoration of James Joyce.

A plaque would be an appropriate way to recognise John Ryan's commitment and influence to Irish literature.

Reply:

The erection of commemorative plaques is governed by the council's Policy on Commemorative Naming of Infrastructure and the Provision of Monuments, Memorials and Plaques, approved by the council at its meeting of 3rd December 2012.

Applications for the erection of commemorative plaques are considered by the Commemorative Naming Committee and must be made on the official form, available at

http://www.dublincity.ie/sites/default/files/content/RecreationandCulture/Documents/Application_form_Commemorative_Naming.pdf

Q.42 Councillor Ruairí McGinley

To ask manager to repair pothole at 10 Ashfield Park, Terenure and resurface road at Ashdale Avenue where road is either not surfaced or unevenly surfaced leading to ponding etc., which further damages surface with frost etc.

Reply:

Arrangements will be made to carry out a repair to this pothole as soon as possible. Other remedial works on Ashdale Avenue will be put on Road Maintenance Services' Works List.

Q.43 Councillor Ruairi McGinley

To ask the manager to repair (details supplied)

Reply:

The burst water main at details supplied was fixed. The councillor may obtain further information from Irish Water, PO Box 860, South City Delivery Office, Cork City, tel.: 1890 278 278 or email: localrepsupport@water.ie

Q.44 Councillor Paddy McCartan

To ask the manager to address concerns of residents on Anglesea Road over the new development "Dunluce", and the possible increase in flooding to adjacent properties. Dunluce is located directly to the rear of Lower Anglesea Road and on the bank of the Dodder. The development is in the final phase of construction.

- a. Has the development complied with all planning requirements?
- b. Has there been any deviation from planning permission granted during construction?
- c. Can planners confirm that the construction undertaken by the developer will not result in flooding for surrounding properties?

Reply:

Planning permission was originally granted for a residential development on the c.0.49 hectare site, comprising the demolition of an existing two-storey dwelling "Dunluce" and the construction of an apartment development in 4 blocks. (Planning References: Reg. Ref.: 4049/09 and PL 29S 235671)

An extension of Duration of Permission was subsequently granted to allow for the completion of works (Reg. Ref.: 4049/09X1). The Drainage Division raised no objection to the granting of the extension of duration.

The original application was subject to 19 conditions. Condition 6 required the following:

Water supply and drainage arrangements, including the attenuation and disposal of surface water, shall comply with the requirements of the planning authority for such works and services. The recommendations of the submitted Flood Risk Assessment and Management Plan shall be fully implemented. Prior to commencement of development, the developer shall submit to and agree in writing with the planning authority details in respect of:

(a) protection of the foul drainage system from surface water ingress,

(b) a flood warning system for 25 year flood event, and

https://www.google.ie/search?espv=2&biw=1270&bih=362&q=malaga+nightlife&npsic=0&rllfq=1&rllha=0&rllag=36723020,-4421423,100&tbm=lcl&ved=0ahUKEwjTqc7L0Z3PAhWrJsAKHRQdArEQtgMIHQ&tbs=lf_msr:-1,lf:1,lf_ui:9&sqi=2

(c) a surface water drainage system including the outfall to River Dodder and a work method for its construction.

This condition was the subject of a compliance submission and was considered acceptable by the Drainage Division.

- c) With regard to river flooding the new development will not have any influence as it is behind new flood walls and embankments designed to retain the estimated 100 year river flood plus a 300mm to 500mm safety margin.

Q.45 Councillor Paddy McCartan

To ask the manager to ascertain whether there has been any follow-up to a question put in six months ago on plans to build a footpath at Beaver Row, Donnybrook. The matter had been referred to the Engineering Road Design and Construction Department for examination.

Reply:

The Road Design and Construction Division have no plans to provide a footpath at this location on Beaver Row/Beech Hill Road and are unaware of any funding for it. A retaining wall would also be needed at the back of the footpath in order to retain the grass bank. While there is a public lighting pole located at the edge of the road it is not certain that the grass bank is in the ownership or charge of Dublin City Council.

Q.46 Councillor Frank Kennedy

To ask the Area Manager when the changes recommended in correspondence ref 15157/15671/SH/CK dated 14 July 2016 will be implemented. For completeness, the e-mail stated:

Our Ref: 15157/15671/SH/CK
Please quote Our Ref:
14th July, 2016

Re: Leeson Street Bridge.

I refer to your email of 10th November, 2014, and your joint Motion with Councillor Clare Byrne, submitted to the South East Committee meeting of 8th December, 2014, regarding the above. I wish to inform you that the Traffic Advisory Group, at its meeting of 24th May, 2016, recommended the following measures:

Rescind the Pay and Display Parking on the southern side of Sussex Road from a point approximately 8 metres east of lamp standard No.26 extending eastwards for 11 metres, and replacement at the same location with a loading bay with hours of operation Monday to Saturday 07.00 - 18.00

These measures will be implemented subject to the completion of the necessary statutory consultation process with the Gardaí.

The Traffic Advisory Group also recommended the following measures to be considered for inclusion in a future Works Programme subject to the availability of funding:

Rescind the loading bay in front of Leeson Lounge, Leeson Street Upper
Relocate Dublin Bus Stop No. 847 south in front of Leeson Lounge, Leeson Street Upper (in the rescinded loading bay area).

Partially remove the existing build-out adjacent to relocated Bus Stop No. 847, to facilitate a third bus.

Install an extended Primary Signal Pole or cantilevered pole at the pedestrian crossing adjacent to the Lesson Lounge, to ensure adequate visibility when buses are stationary.

Reply:

The proposed works will be considered for inclusion in the 2017 Works Programme.

Q.47 Councillor Frank Kennedy

I asked and received the following question and answer at the October meeting of Dublin City Council:

To ask the area manager (a) to install addition “No Cycling” signs stencilled onto the promenade on Sandymount Strand in circumstances where there are a number of points where cyclists can enter the promenade without seeing a no cycling sign, and (b) to arrange for the Parks Department to conduct a review of the extent of impermissible cycling which takes place on the promenade between 8-9am and 4.30-6pm on weekdays.

Reply:

(a) Road Markings are prescribed as per the Department of Transport Traffic Signs Manual; there is no provision for the installation of “No Cycling” road markings. Dublin City Council is currently finalising a Road Safety Strategy with the focus on public awareness education with particular reference to non-cycling on footpaths. The ‘RESPECT’ campaign is due to roll out in early 2017.

The operator of Coca-Cola Zero dublinbikes has been contacted with regard to the proposal to initiate a public awareness campaign with regard to the rules of the road, with particular reference to non-cycling on footpaths. Coca-Cola Zero dublinbikes members will be reminded to always obey the rules of the road and to never cycle on footpaths. This message is already on bike stands and online for members, and will be communicated to members to coincide with commencement of similar safe cycling initiatives by Dublin City Council.

(b) Parks and Landscapes Service will review the issue of cycling at this location in conjunction with the Cycling and Walking promotions Officer.

However, the reply is highly confusing because as No Cycling signs have now been stencilled at the entrance to the promenade. To ask the area manager for a report on the precise position co-ordinated across the various departments of the Council.

Reply:

These are old stencils installed some time ago at the entrance to the promenade and will be reviewed in the context of the recommendations within the new Dublin City Council Road Safety Strategy.

Q.48 Councillor Frank Kennedy

To ask the Area Manager why Dublin City Council has removed the blue barrel at beginning of the Irishtown Nature Reserve walk?

Reply:

Household waste was constantly been dumped into the blue barrel which was making it extremely heavy for our staff member to empty. For this reason it was decided to remove this barrel.

Q.49 Councillor Frank Kennedy

As Dublin City Council has removed the blue barrel at beginning of the Irishtown Nature Reserve walk, and as there is now only a black cast iron bin, to ask the Area

Manager, in circumstances where it is very difficult for people such as Tidy Towns volunteers to empty a bag of rubbish collected on either the beach or the nature walk, to make adequate provisioning for waste disposal at this location.

Reply:

Waste Management Service, in conjunction with any organised clean-up, will collect all bags of litter at an agreed location. Contact details to make such an arrangement are below.

The Tidy Towns volunteers should leave the bags of collected rubbish adjacent to black cast iron bin and it will be collected when the bin is being emptied. They should also liaise in this regard with the District Parks Officer who will facilitate the very worthy efforts of the Tidy Towns group.

Q.50 Councillor Frank Kennedy

To ask the Area Manager (1) to explain the rationale behind the following decisions at Creighton Street, (2) whether the residents were consulted, and (3) if the residents were not consulted, why not:

- (a) Plant trees;
- (b) Install new lights; and
- (c) Reduce the parking available on the residential side of the street

A number of residents have indicated that they do not support these proposals. It is anticipated that the trees may block out natural light further.

Reply:

Construction is currently underway on sites adjoining Windmill Lane and Creighton Street. Post construction Hibernia Reit is required to reinstate the streets in accordance with the requirements of Dublin City Council (DCC). Discussions have taken place in this regard with several departments of DCC in order to agree the standards and layout for the reinstatement works. Hibernia Reit have undertaken to reinstate the streets to a higher standard and quality than existing and in accordance with the latest guidance i.e. DMURS. The works will involve widening footpaths, resurfacing, new public lighting and some tree planting.

An information meeting was held in DCC on November 18th to advise local councillors of the proposed reinstatement works. The information has been distributed by local councillors to local residents and comments have been received via email.

In light of concerns of residents on Creighton Street, the proposals are being re-examined. The consultants working on behalf of Hibernia Reit have been requested to revise the layout on Creighton Street to remove provision of trees from the west side of Creighton Street and to reinstate some parking on the east side of the street. (The original proposals provided one additional car parking space on the west side of the street.) DCC awaits revised drawings.

The revised proposals were circulated to area councillors on the 8th December.

Q.51 Councillor Frank Kennedy

In circumstances where I have been approached by the Chair of the Board of Management of Star of the Sea National School, Sandymount, Dublin 4, to ask the area manager to instigate a full review of the flow of traffic on Leahy's Terrace, Sandymount, Dublin 4 given the ever present and substantive threat of an accident

occurring at this location. For many years the situation which entails when children are brought to and collected from school has created serious risks to the welfare of all users of Leahy's Terrace such that the present position requires review. This review should include an observation of the situation on a weekday morning during the school term.

Reply:

The matter will be examined by the Area Engineer. The councillor will be informed of the recommendation in due course.

Q.52 Councillor Frank Kennedy

To ask the area manager to provide an update on the attempts being made by the Planning Department to find an alternative site for the Metropole advertising sign proposed for Donnybrook at the November meeting of Dublin City Council. Fire officers in Donnybrook Fire Station have expressed the concern that this sign could present problems obstructing the view of fire appliances and ambulances leaving the station. Correspondence to this effect, if required, can be furnished on request.

Reply:

The process of identifying the suitability of alternative sites is ongoing and due to be completed by the end of December. The suitability of any potential site is assessed having regard to traffic safety, visual impact and other planning requirements. However, it is also necessary to satisfy a number of other criteria;

1. The site must be commercially viable and able to generate the appropriate quantum of revenue. This viability is also related to the level and quality of existing outdoor advertising in the area.
2. The site must meet health & safety requirements for staff performing ongoing maintenance and any required repair.
3. The site must satisfy public liability insurance requirements.
4. The site must meet all technical and engineering requirements including;
 1. Impact of ground conditions and underground utilities on foundation design.
 2. Availability of power supply.
5. Survey work is required using ground penetrating radar.
6. Test trenching is carried out if sites have been shortlisted.

Q.53 Councillor Chris Andrews

Can the manager have the kitchen window at *details supplied replaced as it cannot be locked and is currently dangerous condition and also have the heating in the bedroom repaired with the blockage under the flooring cleared once and for all?

Reply:

The Area Maintenance Officer is making arrangements to have a contractor call to this dwelling to check the window and carry out any necessary repairs to same. Arrangements will be made to have the radiator/heating in the bedroom checked.

Q.54 Councillor Chris Andrews

Can the manager state when it is likely that Ringsend Bridge will have the work done on it to place the walkway on the outside of the existing bridge and how much is this essential work likely to cost?

Reply:

The draft emerging preferred option for the Dodder Greenway proposes cantilevered walkways on either side of Ringsend Bridge. At present, given the considerable

Dublin City Council resources required for the Luas Cross City project and NTA funding priorities, the project is to be paused. Dublin City Council is not currently in a position to say when the work will be done. Early indicative costs of €300,000 per boardwalk have been provided. However, these cost estimates may rise as the design develops.

Q.55 Councillor Chris Andrews

Can the manager clean gullies in Beechill of all the leaves blocking them up?

Reply:

25 of 28 gullies on Beech Hill Drive and 13 of 15 gullies on Beech Hill Avenue were cleaned on 5th December 2016

The gully team will return on 6th December to finish off the roads not yet completed.

Q.56 Councillor Chris Andrews

What is the current status of the Moss Street / Luke Street sites in the context of redevelopments?

Reply:

A new scheme of 21 social housing units will be built at Moss Street as part of the overall development of this site in exchange for a land transfer. It is anticipated that a report to dispose of the Moss Street site will be included on the agenda of the South East Area Committee in January 2017. In view of agreement reached on the future of the Moss Street site, it is the Housing Development Department's intention to now consider the future development of the Luke Street site and this will be assessed in early 2017.

Q.57 Councillor Chris Andrews

Will the chief executive have the bollard outside *details supplied reinstated as I was told this would be done previously, but it has yet to be done?

Reply:

This is on Road Maintenance Services' Works List and will be carried out as soon as a crew becomes available.

Q.58 Councillor Chris Andrews

Will the manager give an update on why the issues surrounding Longboat Quay are taking so long to resolve and when does the manager expect a solution to be found?

Reply:

Dublin City Council is currently involved in an ongoing deliberative, legal and remedial process which the Council, Longboat Quay Management Company Ltd and third parties are engaged in. There are at present ongoing Commercial Court proceedings entitled Longboat Quay Management Company Limited Plaintiff v Dublin City Council, Gendsong Limited (in receivership), Declan Taite & Anne O Dwyer (the receivers) the High Court Record No 2015 8313P.

Q.59 Councillor Chris Andrews

Can the manager contact or fine the waste collection companies who do not collect the bins on Lennox Street at the allotted times on Tuesday evening and sometimes not even on the Wednesday leading to the rubbish ending up all over the street?

Reply:

Waste Management Services Division has contacted the main service provider for this street and made them aware of the complaint and that enforcement action may be taken in the event of collections occurring outside of the allotted times catered for in the bye laws or in the event of collections not taking place.

Q.60 Councillor Chris Andrews

Can the manager have the slats / railings surrounding Beechill replaced with metal / steel fencing that looks well but more difficult to break?

Reply:

A survey of the railings will be carried out in 2017 to ascertain the extent of the broken wooden slats and get estimates of the cost to replace with metal slats. All replacements will be subject to funding being available.

Q.61 Councillor Chris Andrews

Can the manager have the flat at *details supplied insulated as given the position of the flat they are experiencing disproportionate dampness and they have a new baby who is getting a lot of chest infections associated with the severe dampness or alternatively can the manager consider this family for a transfer?

Reply:

Arrangements are being made to have this flat inspected in relation to the report of dampness over the coming two weeks.

Q.62 Councillor Chris Andrews

Can the manager outline the status of the process for relocating the JC Decaux sign in alternative site from outside fire station in Donnybrook?

Reply:

The process of identifying the suitability of alternative sites is ongoing and due to be completed by the end of December. The suitability of any potential site is assessed having regard to traffic safety, visual impact and other planning requirements. However, it is also necessary to satisfy a number of other criteria;

1. The site must be commercially viable and able to generate the appropriate quantum of revenue. This viability is also related to the level and quality of existing outdoor advertising in the area.
2. The site must meet health & safety requirements for staff performing ongoing maintenance and any required repair.
3. The site must satisfy public liability insurance requirements.
4. The site must meet all technical and engineering requirements including;
 1. Impact of ground conditions and underground utilities on foundation design.
 2. Availability of power supply.
5. Survey work is required using ground penetrating radar.
6. Test trenching is carried out if sites have been shortlisted.

Q.63 Councillor Frank Kennedy

To ask the area manager to clarify whether there is a community usage proviso for the Metropole advertising signs (for instance, as a planning condition) and, if there is, to provide details of same and of how community groups can avail of the signage.

Reply:

The four approved Part 8 Metropoles do not include a condition for community use as this is dealt with under the original Public Amenities contract. Under this contract, Dublin City Council has access to 38 JCDecaux outdoor advertising sites each month. Under the terms and conditions of the contract, Dublin City Council can run two civic advertising campaigns per month.

The advertising sites are specifically used to promote the services of Dublin City Council, including public information campaigns. The sites are also used to promote city wide events, festivals and other major flag ship events that are happening in the city. The sites are also used to showcase Dublin as a tourist destination for major sporting and cultural events which is done in collaboration with our other stakeholders in the city.

It is generally not feasible to make these sites available for local community groups due to the requirement for the event / messaging being promoted to have city wide and civic relevance beyond immediate local areas, and also having regard to the scheduling and timings involved in design, print and advertising cycles. The civic information network is managed by the Media Relations Section of Dublin City Council.

Q.64 Councillor Frank Kennedy

To ask the area manager, in circumstances where the former St. Mary's Carmelite seminary on Bloomfield Avenue has been placed on the market, (a) what is the status of the buildings on this site in terms of preservation and conservation, and (b) whether the buildings on the site are, from a planning perspective, exposed to the risk of demolition.

Reply:

The buildings St. Mary's Carmelite Seminary on the south side of Bloomfield Avenue are not on the Record of Protected Structures.

The lands are zoned Z15: To protect and provide for institutional and community uses. There is no recent planning history. The last planning application 4338/04 relates to its use as a retreat centre.

Q.65 Councillor Frank Kennedy

To ask the area manager to procure from the NTA copies of the various maps for the proposal for the Merrion Gates underpass / Merrion Road - Strand Road overpass and to place copies of these maps in Ringsend and Pembroke libraries so that they can be viewed by members of the public, as well as to offer a set of the maps to Star of the Sea National School.

Reply:

The documents are available for inspection online at the following location:

https://www.nationaltransport.ie/wp-content/uploads/2016/10/Sandymount_Blackrock_Study-Public_Consultation_Document.pdf

Hard copies have been made available for inspection at Ringsend, Pembroke and Pearse Street Libraries, as requested.

Q.66 Councillor Sonya Stapleton

To ask the Manager to have a handrail attached from ground floor up to second floor of O'Rahilly House, Ringsend. Lady contacted me to say her mother struggles to get up and down the stairs from her flat as there is only one hand rail, details supplied.

Reply:

According to our records, the applicant (details supplied) has not applied to Dublin City Council for a transfer. Dublin City Council will issue the applicant with the appropriate form.

Q.67 Councillor Sonya Stapleton

To ask the manager to have cistern replaced in details supplied.

Reply:

The cistern in this dwelling was installed by the tenant and the bathroom tiled subsequently, also by the tenant, therefore the responsibility for replacing the cistern which also means replacing the tiles lies with the tenant.

Q.68 Councillor Sonya Stapleton

To ask the manager to supply councillor with list of council properties painted in past year and list of properties to be painted in 2017 with a possible time line. Mercer Street flats and Cuffe Street are an eyesore to residents.

Reply:

The Manager of our Painting Squad reports the following complexes were painted in 2016:

- Markievicz House (remainder).
- Rathmines Avenue.
- Leo Fitzgerald House.
- Canon Mooney Gardens (in progress).
- Maxwell Court (in progress).
- Beechill Villas.

The following flat complexes are listed for inclusion in our 2017 painting programme. No specific timeline can be given at this stage until this programme is confirmed.

- Mercer House.
- Cuffe Street.

Q.69 Councillor Sonya Stapleton

To ask the manager to contact Care After Prison to arrange funding / grant to maintain and enhance the work they are doing on the garden project of O'Carroll Villas.

Reply:

Robert Chester was contacted by Care After Prison (CAP) in early October seeking assistance and they were informed of the grant process and closing date of October 28th 2016. We have not received any grant form from them in the process for 2017. As a result we will have to assist with benefit in kind and we will do so if they can make contact with us at the South East Area office.

Q.70 Councillor Dermot Lacey

In reply to Question Number 24 at the meeting of the Area Committee on the 8th December 2014, a commitment was given to plant trees at the Seafort Terrace / Avenue, Sandymount. Could the manager now arrange for that commitment to be honoured?

Reply:

The location has been assessed for tree planting and regrettably it was found to be unsuitable and therefore it is not possible to undertake tree planting at this location.

Q.71 Councillor Claire Byrne

To ask the area manager if she would consider trialling eco friendly anti-graffiti paint on buildings along the Grand Canal between Charlemont and Leeson Street Bridge as a measure to help address the on-going issue of graffiti in this area.

Reply:

The area in question relates mainly to the back walls of houses along Adelaide Road. As these houses are privately owned, the legal responsibility for removal of graffiti from their own property rests with each individual owner / occupier. The application of an anti-graffiti coating is also a matter for them to consider.

Q.72 Councillor Claire Byrne

To ask the area manager to please address the ongoing issues of anti social behaviour in Ringsend Park, in particular *details supplied. Fires are continually being lit there and loud blaring music played frequently. Last week two wheelie bins were taken from the houses and were used for the fires. Can the area manager please contact the Gardaí and request an increased presence in the area.

Reply:

Parks Services has been working with local Gardaí in recent months on this issue including having the matter discussed at the Ringsend Irishtown Community Safety Forum.

Anti-social behaviour is a matter for An Garda Síochána and may be reported to them at their Irishtown Station, 57a Irishtown Road, Dublin 4, tel.: 666 9600, email:

Q.73 Councillor Claire Byrne

To ask the area manager if she would consider a public open design competition to paint the sand bag containers on Sandymount Strand to make them more visually pleasing on this popular promenade.

Reply:

Dublin City Council welcomes initiatives with regard to the strategic storage containers of sandbags used at times of flooding. It is important for residents in the area to ensure that they have adequate house flood protection measures in place to deal with flooding.

The South East Area will pursue this idea in 2017, taking into account local opinion, to make these containers an attraction along the promenade.

Q.74 Councillor Claire Byrne

To ask the area manager for a progress report on plans to address the issues at Leeson Street Bridge where the cycle / pedestrian path meets the bridge causing a dangerous bottle neck for the cyclists and pedestrians.

Reply:

The area in question is a shared space for cyclists and pedestrians on the north-west side of the Grand Canal. It is not feasible to segregate cyclists and pedestrians in this area due to insufficient space. Delineation or using a painted line to mark off space for cyclists and pedestrians is also not an option.

A shared space along a cycle/pedestrian route is a space where cyclists are obliged to yield to pedestrians and all users should show due consideration for each others' safety by proceeding through the area in an orderly manner.

Q.75 Councillor Claire Byrne

To ask the Area Manager the following in relation to the new dog litter awareness campaign in 2016:

1. How much of the 2016 budget allocated for the new dog litter awareness campaign for the South East Area has been spent to date?
2. How many dog litter fines have been issued since the campaign was launched?
3. How many have been paid since the campaign was launched this year?

Reply:

1. €25,500 has been spent to date in the South East Area.
2. 79 fines have been issued in respect of the dog fouling enforcement campaign in 2016.
3. 49 fines have been paid to date.

This campaign ran from May until the end of November. Authorised staff, supported by An Garda Síochána, issued nine fines of €150 under Section 22 of the Litter Pollution Act 1997, to dog owners who failed to clean up after their dog. Of these, six have to date been paid. In addition, Warning Notices were served on two dog walkers.

Dog Wardens also patrolled some of our parks during this campaign and they requested dog walkers to produce evidence that they had a valid dog licence and that they also carried bags for collecting dog dirt. One hundred and twenty-seven 10 day notices were issued by them to dog walkers in respect of failure to produce a valid dog licence. Of these, where valid licences were not subsequently produced, seventeen fines of €100 were issued. In addition two fines of €100 were issued to dog owners in respect of un-muzzled restricted breeds.

Staff, while on patrol, also spoke to numerous dog walkers about their responsibilities and rewarded some of the many who were compliant with small gifts. One issue that was raised on numerous occasions was the lack of bins in the vicinity of some of our parks. However, it is expected that an initial batch of 30 dog litter bins will be installed within a short period of time. Overall, it was found at times of patrol that the vast majority of dog walkers in our area are compliant. The budget allocated in 2016 for this South East area campaign was fully spent.

Q.76 Councillor Claire Byrne

To ask the area manager for a progress report on the following motion that was agreed at the November 2015 meeting:

“That this area committee supports proposals to develop the derelict site on the corner of New Street and New Street Gardens into housing for elderly people.”

Reply:

A proposal from the Peter McVerry Trust for the construction of 6 units at this site under the Capital Assistance Scheme has been made and the capital appraisal has been sent to the Department of Housing, Planning, Community & Local Government.

Q.77 Councillor Claire Byrne

To ask the area manager for an update on the progress of the search for a premises for a mixed martial arts facility in the Ringsend or Irishtown area.

Reply:

There is no capacity in Irishtown Stadium for any additional clubs. The mixed martial arts club(s) would therefore need to identify a facility and this office has had no information that a suitable facility has been identified.

Q.78 Councillor Claire Byrne

To ask the area manager for an update on addressing the issues in Longboat Quay?

Reply:

Dublin City Council is currently involved in an ongoing deliberative, legal and remedial process in which the council, Longboat Quay Management Company Ltd. and third parties are engaged. There are, at present, ongoing Commercial Court proceedings entitled Longboat Quay Management Company Limited Plaintiff v Dublin City Council, Gendsong Limited (in receivership), Declan Taite & Anne O Dwyer (the receivers) the High Court Record No 2015 8313P.

Q.79 Councillor Claire Byrne

To ask the area manager whether it is permitted to commence works on a building without planning permission for a change of use a being granted and what are the consequences of this. This is in particular relation to the following building, *details supplied. Can the area manager please provide all details regarding the planning applications and permissions for this premises.

Reply:

Under the parent permission for this development the approved use of the unit concerned is media / office / retail. A new tenant recently took over the lease and fitted it out as a shop selling ice-cream and other snacks. However, it does contain a number of tables/chairs for use by customers. An enforcement file has been opened on this development.

In October 2016, a planning application was lodged for a change of use from media / office / retail to café/restaurant. However, this application has been invalidated as it did not adequately describe the development that has taken place.

South East Jan 17 Area Agenda 09/01/17(TAG Date: 20/12/16)											
Item	Request	Ref	Road	Post-code	Topic	Request Description	Request by	TAG Result	TAG Comments	Sec	Date Rec'd
1	Parking Prohibitions	35199	ARDEE ROAD (SE-EA)	D6	Double Yellow Lines (Extend)	Request for extension of DYL from Military road junction to extend into spot occupied by marked parking bay.	Resident	Not Recommended	The carriageway is in excess of 8m at this location. Dublin City Council requires a minimum of 6.5m to cater for double sided parking. Under the Road Traffic Act there is an onus on all road users to drive with due care and attention on a public roadway.	0	22/11/2016
2	School Warden	15077	AUNGIER STREET (SE-EA)	D2	School Warden	At the Old Aungier Street pub at the junction of Digges Street Upper.	Councillor Stapleton	Not Recommended	The Road Safety Unit in charge of School Wardens have reassessed following a request from the Area Engineer and have reported that the warrant is not met. The location will be assessed for a Pedestrian Crossing.	0	10/11/2014
3	Parking Prohibitions	30661	BAGGOT STREET LOWER (SE-EA)	D2	Loading Bay	And rescindment of double yellow lines in the vicinity of Café Sol, No. 46.	Resident	Not Recommended	Not recommended. HGV's are exempt from parking restrictions on Double yellow lines.. Under the Road Traffic Act "(b) Paragraph (a) shall not apply to a large vehicle parked while goods are being loaded in or on to it or unloaded from it, for a period not exceeding thirty minutes from the commencement of the parking."	0	08/04/2016
4	Traffic Conditions	28776	BRIGHTON SQUARE SOUTH (SE-EA)	D6	Traffic Calming	On the road.	Dublin City Council area office	Not Recommended	Brighton Square South is already traffic calmed. It is good practice to space vertical deflections as regularly and frequently as practicable. Introducing additional ramps would not comply with current design standards and would encourage harsh braking and consequent heavy acceleration. It is therefore not recommended to introduce an additional speed ramps as the warrant has not been met.	0	08/01/2016
5	Parking Prohibitions	15834	BROOKVALE ROAD (SE-EA)	D4	Double Yellow Lines (Extend)	At the exit of the dodder pathway, on the river side of the road.	Resident	Recommended	Extend existing Double Yellow Lines on the Southside of Brookvale Road from a point 48m Southwest of LS no. 8 for 9m South-westwards.	0	07/12/2014
6	Traffic Conditions	20373	BURLINGTON ROAD (SE-EA)	D4	Traffic Calming	Widening footpath for traffic calming, suggests area could be used for Dublin Bike scheme	An Garda Síochána	Recommended	Recommend that the junction be included for review on the Future Works Programme. The geometric design of the junction should be technically assessed in accordance with the Design Manual for Urban Roads and Streets (particularly review the tightening of footpath radii' and the installation of build outs on Burlington Road to reduce the carriageway).	0	23/09/2015
7	Parking Prohibitions	27783	BURLINGTON ROAD (SE-EA)	D4	Pay & Display & Permit Parking	Outside No. 32.	Business	Not Recommended	Changes to the Pay & Display arrangements are not recommended at this time. Parking Enforcement has issued a total of 44 Parking Permits on Burlington Road to date which has a capacity of 144 spaces.	0	12/11/2015
8	Parking Prohibitions	29466	CASTLEWOOD AVENUE (SE-EA)	D6	Double Yellow Lines	Outside No. 12	Resident	Not Recommended	Under The Road Traffic (Traffic & Parking) Regulations, Section 36 paragraph(2) g; "A vehicle shall not be parked in any place, position or manner that will result in the vehicle obstructing an entrance or an exit for vehicles to or from a premises, save with the consent of the occupier of such premises;" It is not recommended to introduce parking restrictions where restrictions are already covered under the law, such as placing Double Yellow Lines across entrances, as this would lead to a proliferation of same and additional expense due to maintenance etc. Infringements of the Act should be reported to Dublin Street Parking Services Ph.6022500 as they occur.	0	08/02/2016
9	Parking Prohibitions	32430	CASTLEWOOD TERRACE (SE-EA)	D6	Double Yellow Lines	Outside property Nos. 19 and 22.	Resident	Not Recommended	Under The Road Traffic (Traffic & Parking) Regulations, Section 36 paragraph(2) g; "A vehicle shall not be parked in any place, position or manner that will result in the vehicle obstructing an entrance or an exit for vehicles to or from a premises, save with the consent of the occupier of such premises;" It is not recommended to introduce parking restrictions where restrictions are already covered under the law, such as placing Double Yellow Lines across entrances, as this would lead to a proliferation of same and additional expense due to maintenance etc. Infringements of the Act should be reported to Dublin Street Parking Services Ph.6022500 for enforcement under the law. This issue will be referred to Dublin Street Parking Services.	1	01/07/2016
10	Traffic Conditions	35400	CLAREVILLE ROAD (SE-EA)		Bus Stop (General Query)		Councillor Freehill	Not Recommended	The bus stop on Clareville Road near the junction with Kenilworth Park was observed between 08.00 am - 10.00 am, the times indicated as problematic. The stop was observed on a normal school day and 12 no. buses used the stop between this period. (A detailed report is attached). The maximum number of passengers waiting to board at any given time was 2 people and the maximum standing time of any bus was 36 seconds. During the two hour period observed, at no time did the use of the bus stop impact upon Kenilworth Road and the traffic movements at its junction. It is therefore not recommended to move the stop at this location.	0	12/12/2016
11	Parking Prohibitions	17291	CLYDE ROAD (SE-EA)	D4	Double Yellow Lines	Outside No. 4.	Resident	Not Recommended	Under The Road Traffic (Traffic & Parking) Regulations, Section 36 paragraph(2) g; "A vehicle shall not be parked in any place, position or manner that will result in the vehicle obstructing an entrance or an exit for vehicles to or from a premises, save with the consent of the occupier of such premises;" It is not recommended to introduce parking restrictions where restrictions are already covered under the law, such as placing Double Yellow Lines across entrances, as this would lead to a proliferation of same and additional expense due to maintenance etc. Infringements of the Act should be reported to Dublin Street Parking Services Ph.6022500 for enforcement under the law. Dublin Street Parking services have the ability to tow a vehicle if access is required.	0	19/03/2015

12	Traffic Signals	17661	CREIGHTON STREET (SE-EA)	D2	Traffic Lights	At the junction of Creighton Street and Hanover Street East.	Councillor Andrews	Recommended	Public realm improvements are currently underway on Creighton street, a controlled crossing (Zebra Crossing) is included to be installed on a trial basis.	0	13/04/2015
13	Parking Prohibitions	29023	EARLSFORT TERRACE (SE-EA)	D2	Pay & Display & Permit Parking	And rescindment of bus cage markings close to the junction of Leeson Street and St. Stephens Green.	Dublin City Council Parking Enforcement	Not Recommended	Service request (SR) not recommended. Airlink 757 operates from this bus stop and has an active timetable on dublinbus.ie.	0	21/01/2016
14		16873	ESTATE COTTAGES (SE-EA)		Double Yellow Lines (Extend)	Request to extend the double yellow lines into an L shape facing the canal to avoid parking confusion.	Resident	Recommended	Install Double Yellows on the Northern side of Estate Cottages from a point 64m (approx) Northeast of LS no. 2, extending North-eastwards for 2.6m.	0	
15	Traffic Signs	33697	FREDERICK STREET SOUTH (SE-EA)	D2	3.5 Tonne Limit	From junction with Setanta Place to Nassau Street.	Dublin City Council Traffic Management	Recommended	3.5T on Frederick Street South at the junction with Setanta Place for traffic heading north between Setanta Place and Nassau Street.	0	12/09/2016
16	Traffic Conditions	33794	GANDON CLOSE (SE-EA)	D6	Yellow Box (Extend)	Difficult to make safe right turn unless yellow box is extended	Resident	Not Recommended	Not recommended. The existing yellow box extends the width of the junction entrance and is consistent with other yellow boxes throughout the city. The Traffic Department does not provide convex traffic mirrors, they give a distorted view of approaching traffic which is potentially hazardous and also because such mirrors would attract a high degree of vandalism with associated maintenance costs.	0	13/09/2016
17	Parking Prohibitions	20386	GILFORD DRIVE (SE-EA)	D4	Double Yellow Lines (Extend)	Outside the gates of No 20	Resident	Not Recommended	Under the Road Traffic Act it is illegal to block an entrance. "A vehicle shall not be parked in any place, position or manner that will result in the vehicle obstructing an entrance or an exit for vehicles to or from a premises, save with the consent of the occupier of such premises". Infractions should be reported to Dublin Street Parking Services tel. no. 01 6022500 as they occur.	0	24/09/2015
18	Parking Prohibitions	29758	GOLDEN LANE (SE-EA)	D2	Parking Prohibition	Parking prohibition for Sundays	Dublin City Council Traffic Management	Recommended	Rescind single yellow line and extend existing Double yellow line on the North side of Golden Lane, from a point 9m East opposite of LS no. 1 extending Eastwards for 8m. Amend hours of operation for Single Yellow line on the North side of Golden Lane from 07.00 – 19.00 Mon – Sat to 07.00 – 19.00 Mon – Sun.	0	15/02/2016
19	Parking Prohibitions	27631	GREENORE TERRACE (SE-EA)	D2	Double Yellow Lines (Rescind)	From outside 32	Resident	Not Recommended	Not recommended. Due to the proximity of the junction with Hogan Avenue vehicles parking here would impact negatively on the junction. It is also illegal to park within 5metres of a junction.	0	06/11/2015
20	Parking Prohibitions	34622	GROVE AVENUE (SE-EA)	D6	Double Yellow Lines	Request for DYLS alongside houses	Resident	Not Recommended	Street furniture is a matter for the Public Domain Officer. Double yellow lines are not recommended on the Eastside of Grove as there are existing parking prohibitions on the West side of the lane and introducing further parking restrictions would leave Residents with nowhere to park. Should the Residents wish they can apply to Parking Enforcement to introduce Pay & Display which would formalise the parking arrangements along the laneway. Dublin City Council will proceed with the preparation of a Pay and Display and Residents' Permit Parking Scheme where it is first established that there is a demonstrable and clear desire for a Scheme. On receipt initially of written supporting evidence from 25% of households of the road, the request for a Parking Scheme will be referred to the Traffic Advisory Group for examination and report.	3	21/10/2016
21	Parking Prohibitions	34730	GROVE AVENUE (SE-EA)	D6	Disabled Parking Bay (Residential)	Outside No. 2.	Resident	Recommended	Service request (SR) recommended. Due to the existing DYLS along the Westside of Grove Avenue the disabled bay is recommended to be installed opposite no. 2 Grove Avenue, on the East side of the road, to maximise the available remaining spaces for parking. Stat: Install Disabled bay on the Eastside of Grove Ave from a point 22.5m South of LS no. 1 extending Southwards for 5.5m	0	26/10/2016
22		20180	HANOVER STREET EAST (SE-EA)	D2	Pedestrian Crossing	close to Euro Spar entrance across from Pearse House flats.	Councillor Andrews	Recommended	Public realm improvements are currently underway on Creighton street, a controlled crossing (Zebra Crossing) is included to be installed as part of the works on a trial basis across Hanover St East.	0	
23	Parking Prohibitions	29780	HIGHFIELD ROAD (SE-EA)	D6	Double Yellow Lines (Extend)	from in front of property No.56 to No.58	resident	Recommended	Extend the Double Yellow Lines on the North side of Highfield Road from LS no. 15 extending Westwards for 9m	0	16/02/2016
24	Parking Prohibitions	15044	LARKFIELD GROVE (SE-EA)	D6W	Double Yellow Lines	on either side of the green at approximately Nos. 73/71 and 45/47.	resident	Not Recommended	Parking restrictions in the form of double yellow lines are not recommended on Larkfield grove in the vicinity of the green. The carriage way width is excess of 7m wide. Dublin City Council policy requires a minimum of 6.5m for two sided parking. Although commuter parking may be an inconvenience to local residents it does not constitute the need for unnecessary parking restrictions. Should the residents so wish they could apply to parkingenforcement@dublincity.ie to apply for Pay and Display parking to be introduced.	2	15/11/2014
25	Bus Stop Approvals	31362	LUKE STREET (SE-EA)	D2	Bus Stop Approvals	Rescind the bus terminus on Luke Street.	resident	Not Recommended	Suitable coach parking locations are minimal within reasonable vicinity of the city centre. It is not recommended to alter the coach/bus parking on Luke St, as there is not a more suitable location available. The set down area was altered to facilitate Dublin Fire Brigade who were experiencing difficulties with buses on the east side of the street. Dublin City Council will contact the bus operators and request that the engines are shut down when parked.	0	12/05/2016
26	Parking Prohibitions	19431	MERRION ROAD (SE-EA)	D4	Double Yellow Lines (Rescind)	that were put in place	resident	Not Recommended	Not recommended. The double yellow lines were installed to improve traffic flow, improve sight lines when joining Merrion Road and also to reduce the number of vehicles having to cross the centre line to avoid commuter parking.	0	30/07/2015
27	Parking Prohibitions	14863	MERRION VIEW AVENUE (SE-EA)	D4	Disabled Parking Bay (Rescind Residential)	outside No.7b	resident	Recommended	Rescind Disabled Bay on Merrion View Avenue, Dublin 4, directly outside no.7b	0	21/10/2014

28	Parking Prohibitions	18138	NORTHBROOK ROAD (SE-EA)	D6	Double Yellow Lines	In front of the black gated entrance to lane way accessing Dartmouth Road. Beside the railway bridge.	resident	Not Recommended	Under The Road Traffic (Traffic & Parking) Regulations, Section 36 paragraph(2) g; "A vehicle shall not be parked in any place, position or manner that will result in the vehicle obstructing an entrance or an exit for vehicles to or from a premises, save with the consent of the occupier of such premises;" It is not recommended to introduce parking restrictions where restrictions are already covered under the law, such as placing Double Yellow Lines across entrances, as this would lead to a proliferation of same and additional expense due to maintenance etc. Infringements of the Act should be reported to Dublin Street Parking Services Ph.6022500 for enforcement under the law.	1	14/05/2015
29	Parking Prohibitions	35251	NUTLEY ROAD (SE-EA)	D4	Double Yellow Lines	Request to remove parking space lines and install DYL in its place outside No. 28 at PLS 13.	resident	Recommended	Rescind Pay and Display & Permit Parking on the South side of Nutley Road, from Lamp Stand No 13 for 3.5m South-eastwards and replace with double yellow lines.	0	24/11/2016
30	Parking Prohibitions	19631	OAKLANDS PARK (SE-EA)	D4	Pay & Display & Permit Parking	at Oaklands Park/Serpentine Avenue.	Councillor Smyth	Not Recommended	Dublin City Council will proceed with the preparation of a Pay and Display and Residents' Permit Parking Scheme where it is first established that there is a demonstrable and clear desire for a Scheme. On receipt initially of written supporting evidence from 25% of households of Herbert Green, the request for a Parking Scheme will be referred to the Traffic Advisory Group for examination and report. The supporting evidence may take the form of a number of written requests or a signed petition, indicating names and addresses. No changes recommended at this time.	0	13/07/2015
31	Admin	28704	OAKLEY ROAD (SE-EA)	D6	Engineer Query	Problem with road width and request to maybe remove the on street car parking space	Resident	Recommended	There is insufficient road width should the Pay & Display bay be occupied to pass safely without mounting the footpath. It is therefore recommended to rescind the parking bay opposite no. 4 Wellington Gardens. Rescind Pay & Display and Permit Parking on Oakley Road directly in front of LS no. 9 (single bay) and install Double Yellow lines (approx. 4m).	0	04/01/2016
32	Parking Prohibitions	27615	ORWELL PARK (SE-EA)	D6	Double Yellow Lines	in the vicinity of No. 59.	Councillor O' Connell	Not Recommended	Under the Road Traffic (Traffic and Parking) Regulations 1997 it is illegal to park on a footway. Infringements of the Act should be reported to Dublin Street Parking Services Ph.6022500 for enforcement under the law.	0	06/11/2015
33	Parking Prohibitions	35360	PIGEON HOUSE ROAD (SE-EA)	D4	Disabled Parking Bay (Residential)	request disabled parking bay outside No.15	resident	Recommended	Install Disabled Parking bay on the Southside of Pigeon House Road (adjacent to no. 15) from a point 1.5m East of LS no. 15 extending Eastwards for 5.5m.	0	30/11/2016
34	Traffic Conditions	35394	RANELAGH (SE-EA)	D6	Yellow Box	on the road.	Councillor Feeney Feeney	Recommended	Install yellow box on Ranelagh Road, at the junction with Ranelagh Close, for the full width of the carriageway excluding cycle lanes (6m * 4.5m).	0	12/12/2016
35	Parking Prohibitions	17873	ROSTREVOR ROAD (SE-EA)	D6	Double Yellow Lines (Extend)	existing on the road	resident	Recommended	Extend DYL's on the Westside of Rostrevor Road from a point 14m South of Ls no. 6, extending Northwards for 5m	1	28/04/2015
36	Parking Prohibitions	15857	RUGBY ROAD (SE-EA)	D6	Pay & Display & Permit Parking	To review the Pay and Display and Permit Parking Scheme on the road.	resident	Not Recommended	Under the Road Traffic Act it is illegal to park wholly or partially on a public footpath. Dublin City Council can therefore not introduce lining to delineate partial footpath parking. Rugby road meets the minimum requirement for two sided parking. Dublin Fire Brigade is equipped to remove cars that may block a road by whatever means are necessary.	0	15/12/2014
37	Traffic Conditions	35274	SANDFORD ROAD (SE-EA)	D6	Speed Ramps	Speed ramps or something to slow traffic before P.CROSSING	resident	Not Recommended	Recent speed survey data from December 2016 shows that the 85% percentile speed was recorded at 51 km/h. Speed ramps can only reduce speed down to 50km/h and are not warranted. All appropriate signage is in place as per the Traffic Signs Manual	0	24/11/2016
38	Parking Prohibitions	28080	SANDWITH STREET UPPER (SE-EA)	D2	Double Yellow Lines	at the dished wheelchair ramp, near Fenian Street junction.	Dublin City Council parking enforcement	Recommended	Install Double yellow lines on the Eastside of Sandwith Street Upper from a point opposite LS no. 13, extending 2.5m North and 2.5m South.	0	24/11/2015
39	Parking Prohibitions	19773	SERPENTINE ROAD (SE-EA)	D4	Double Yellow Lines (Rescind)	outside No. 26.	resident	Not Recommended	Not recommended. Due to the proximity of the junction with Serpentine Park vehicles parking here would impact negatively on the junction.	0	24/08/2015
40	Parking Prohibitions	28923	SHELBOURNE ROAD (SE-EA)	D4	Double Yellow Lines	between Nos. 54 and 56.	Councillor Lacey	Recommended	Recommended to reflect the adjoining properties and remove the possibility of parked cars blocking access / sightlines. As follows: Install Double yellow lines on the Eastside of Shelbourne Road in between the dishing of the entrances to house no. 54 and no. 56, adjacent to LS no. 20 – approximately 4.5m.	0	14/01/2016
41	Parking Prohibitions	18126	SOUTH LOTTS ROAD (SE-EA)	D4	Double Yellow Lines (Extend)	at entrance to Gasworks Car park on South Lotts Road	resident	Not Recommended	Due to visibility issues exiting the entrance, it is recommended to rescind one space as follows: Rescind Pay & Display and Permit parking on the Westside of South Lott Road from a point 26m North of LS no. 2, extending Southwards for 5m and replace with double yellow lines.	0	12/05/2015
42	Parking Prohibitions	28156	SOUTH LOTTS ROAD (SE-EA)	D4	Double Yellow Lines	outside No. 37.	resident	Not Recommended	Under The Road Traffic (Traffic & Parking) Regulations, Section 36 paragraph(2) g; "A vehicle shall not be parked in any place, position or manner that will result in the vehicle obstructing an entrance or an exit for vehicles to or from a premises, save with the consent of the occupier of such premises;" It is not recommended to introduce parking restrictions where restrictions are already covered under the law, such as placing Double Yellow Lines across entrances, as this would lead to a proliferation of same and additional expense due to maintenance etc. Infringements of the Act should be reported to Dublin Street Parking Services Ph.6022500 as they occur.	0	26/11/2015
43	Parking Prohibitions	35377	TEMPLE ROAD (SE-EA)	D6	Disabled Parking Bay (General)	Parking space adj. to entrance of St. Philip's Church.	resident	Not Recommended	Rescind Pay & Display from a point 25m West of LS no. 13 extending Westwards for 7m and replace with a Disabled Bay.	0	07/12/2016

44	Traffic Signs	17670	WARRINGTON PLACE (SE-EA)	D2	Children Crossing Sign	between Lower Mount Street across to Northumberland Road.	Councillor Lacey	Not Recommended	Children crossing signs are only erected at the entrances to residential estates from main traffic routes and the requested location does not meet the warrant. There are signalised pedestrian crossings at the junction of Warrington Place / Mount St lower.	0	13/04/2015
45	Traffic Conditions	15172	WILFIELD PARK (SE-EA)	D4	Speed Ramps	at the entrance to the road.	Councillor Paddy McCartan	Not Recommended	Wilfield Road is residential in nature and lightly trafficked. During a site inspection no adverse problems were observed relating to speed or traffic movements. There is on street parking that effectively narrows the carriageway and reduces forward visibility. Wilfield Park is a cul de sac after the junction and is short in length, a minimum of at least 200m of a straight run is required to consider traffic calming. A speed survey was carried out on the 21/09/2016 at the junction of Wilfield Road and Wilfield Park. The 85% percentile speed was found to be 34 km/h and speed violations were 1.08% of all road traffic. Traffic calming is therefore not warranted.	0	11/11/2014
46	Traffic Conditions	19243	WILFIELD PARK (SE-EA)	D4	Speed Ramps	On the section of Wilfield Park which is accessed from Wilfield Road.	Cllr Kennedy	Not Recommended	A speed survey was carried out on the 21/09/2016 at the junction of Wilfield Road and Wilfield Park. The 85% percentile speed was found to be 34 km/h and speed violations were 1.08% of all road traffic. Wilfield Park does not meet the minimum 200m required for physical traffic calming. Traffic calming is therefore not warranted. During a number of site inspections no issues were observed regarding speed, Wilfield road is primarily Residential in nature.	0	13/07/2015

Road Maintenance Services -Works Programme 2017

South East Area	Regional Carriageway Improvements				Regional Footpath Improvements				Regional Other		Local Carriageway Improvements				Local Footpath Improvements				Local Other	
Scheme/Activity	Length	Area	Contract	Direct Lab	Length	Area	Contract	Direct Lab	Contract	Direct Lab	Length	Area	Contract	Direct Lab	Length	Area	Contract	Direct Lab	Contract	Direct Lab
Repairs and Carriageway resurfacing																				
Newgrove Avenue (Section)											100	500	€27,500							
Temple Road (Section)											250	1000	€55,000							
Herbert Park											275	2448	€134,640							
Shrewsbury Road (Section)											387	3600	€198,000							
Haddington Road (between Baggot Street and Northumberland Road)	507	6375	€350,625																	
South Lotts Road (section in vicinity of railway bridge)											135	1544	€84,920							
Kevin Street (between New Bride Street and Wexford Street)	240	3216	€176,880																	
Beaver Row											480	3168	€237,600							
Miscellaneous Direct Labour-Regional									€571,200											
Street Name Plates									€17,500											
Winter Maintenance									€25,000											
Incident Response Unit									€25,000											
Footpath Reconstruction																				
Maxwell Road															89	257	€20,560			
Terenure Road West	1010	4000	€320,000												80	250	€20,350			
Various Locations																				
Ramps																			€100,000	
Miscellaneous Direct Labour-Local																				€571,200
Street Name Plates																				€17,500
Winter Maintenance																				€25,000
Incident Response Unit																				€25,000
Totals		13591	€847,505	€0	0		€0	€0	€0	€638,700	12260	€737,660	€0	507	€40,910	€0	€100,000	€638,700		

Regional Carriageway Improvements
 Regional Footpath Improvements
 Regional Other
 Local Carriageway Improvements
 Local Footpath Improvements
 Local Other
 Totals

Area	Contract	Direct Lab
13,591	€847,505	€0
0	€0	€0
	€0	€638,700
12,260	€737,660	€0
507	€40,910	€0
	€100,000	€638,700
	€1,726,075	€1,277,400



To the Chairman and Members of the
South East Area Committee

With reference to the proposed disposal of a property at Gloucester Street South / Moss Street / Bracken's Lane, Dublin 2 to Brigante Investments Ltd. (subsidiary of Tetrarch Capital Ltd.)

It is proposed to dispose of a site located at Gloucester Street South / Moss Street / Bracken's Lane, Dublin 2, as shown outlined in red on Map Index No. SM-2016-0549, to the proposed purchaser Brigante Investments Ltd, and the City Council shall receive 1 retail unit and 20 turn-key residential units free of charge and 1 residential unit at market value for general social housing purposes subject to the following terms and conditions:

1. That the City Council will dispose of the freehold interest with vacant possession in the property at No. 33-34 Moss Street, Dublin 2, having an area of 726 m² or thereabouts, as outlined in red and shaded pink on the attached map Index No SM-2016-0549.
2. That the City Council will dispose of its Fee simple interest subject to a lease forever dated 19th July 1732 in the area known as Bracken's Lane, off Moss Street, Dublin 2 as shown shaded yellow on the attached map Index No SM-2016-0549. The City Council will commence the process to extinguish the public right of way which currently exists over the lane.
3. That the disposal as outlined at condition Nos. 1 & 2 above are subject to the City Council acquiring the unencumbered freehold title or equivalent (to the satisfaction of the Law Agent) in one stand-alone block of twenty one turn-key residential units (to be defined in the agreement), plus one retail unit only, all on the adjacent site is shown outlined in red on the attached OSI Map Sheet 3264-06 (Plot Ref. No. 1225895-1-1 which is for contract purposes). Twenty turn-key residential units and one retail unit, shall be provided to the City Council, for no consideration.
4. That one two bedroom first floor turn-key apartment unit shall be provided to the City Council at market value, disregarding local authority occupation of the remainder of the block. That the market value (to be agreed between parties) shall be determined when the building as outlined at condition No. 3, has reached practical completion, as certified by the City Architect.
5. That Dublin City Council shall have full control of the entire developed block as outlined at No. 3 and associated open space and shall be granted a 900 year lease @ €1 per annum, if demanded. The basement area shall be excluded from this long lease and there shall be no access (either lift or stairwell) from the basement to the proposed block at No.3. The City Architect must be satisfied that the basement as constructed does not present any structural issues for the building above i.e Council accommodation and the City Council shall be indemnified against all damage or loss arising from the construction, use or operation of the basement area.

6. That the City Council shall be granted a right of way for both pedestrian and vehicular access to the proposed residential block outlined at condition No. 3 over the existing Bracken's Lane and a right of way over the proposed entrance from Gloucester Street South (as shaded yellow on the attached OSI Map Sheet 3264-06 (Plot Ref. No. 1225895-1-1)). The ROW's are indicative and shall be determined by the line of the buildings in the final approved development site plan. Dublin City Council shall have a right to connect to all services along the route of each right of way.
7. That one ground floor retail unit shall be provided in shell and core condition with a fitted shop front and entrance door. A formal plan of the retail unit shall be provided by the proposed purchaser. This unit must be capable of independent usage and should be fitted with a separate metering for utilities i.e. electricity, water, gas, provide connections to telecoms and ISP, a separate sewer connection and all connections required for fire alarm to the main building, as required.
8. That the residential units, as outlined at condition No. 3 above, comprising of 14 x one bedroom apartments and 7 x two bedroom apartments, shall be completed to the Council's specifications, under supervision and approval of the City Architect. Specification shall be agreed by the respective architects of each party. Prior to signing of contract documentation or prior to lodging of planning permission, whichever is the earlier, the Council shall have the right to call for the 14 x one bedroom units to be converted, in whole or in part, to a lesser number of two bedroom units.
9. That the Law Agent shall prepare the necessary contract documents, to include a Building Licence, to be ready for execution by the parties within twelve weeks of the date of issue of the formal approval of the transaction by the Council. The proposed purchaser must execute and return such documentation within four weeks of receipt of same.
10. That an exchange of title to the lands as outlined at condition Nos. 1, 2 & 3 shall be effected by the parties when the building as outlined at condition No. 3, has reached practical completion, as certified by the City Architect.
11. That the Part V obligation shall apply to any other residential blocks approved in the scheme of development, if applicable.
12. That that the proposed purchaser Brigante Investments Limited is a wholly owned subsidiary of Tetrarch Capital Limited.
13. That the proposed purchaser must lodge a planning application for a comprehensive scheme of development of the their lands at this location, to include the City Council's property as outlined at condition Nos. 1 & 2 above, within six months of receipt of the requisite approvals of the City Council to this proposed disposal. If this does not occur the City Council, at its absolute discretion, may decide to rescind this agreement.
14. That the proposed purchaser will be allowed one opportunity to submit a planning application to Dublin City Council and, if necessary, an appeal to An Bord Pleanála.
15. That if planning permission for a comprehensive development is either refused (by Dublin City Council or An Bord Pleanála), or granted subject to onerous conditions, then either party may rescind the agreement within four weeks of the refusal or final grant of planning permission, without penalty or compensation

- due to the other party. All related costs to be borne by the proposed purchaser.
16. That the proposed purchaser must commence work on site within six months of the date of final grant of planning permission and must complete the City Council block as outlined at condition No. 3 above within eighteen months from the commencement date. The Council shall grant a Building Licence in respect of the demolition and development work on the property as outlined at condition Nos. 1 & 2 above.
 17. That the City Council reserves the right to re-enter on the site as outlined at condition Nos. 1 & 2 and resume possession thereof should the proposed purchaser fail to commence and complete the buildings as outlined at condition No. 3 within the specified period or in the event of the proposed purchaser's bankruptcy or insolvency, save in the case of a Financial Institution, which has entered into a mortgage with the proposed purchaser for the purposes of financing development of the site.
 18. That all site investigations (including archaeological investigations), ground works, services connections, planning fees, development and associated professional costs incurred in the delivery of the completed development on the property outlined at condition Nos. 1, 2 & 3 above, shall be borne by the proposed purchaser.
 19. That the proposed purchaser shall ensure that all necessary safety precautions are taken in accordance with Health & Safety Regulations and all other statutory requirements.
 20. That the proposed purchaser shall undertake not to use the said site outlined at conditions Nos. 1, 2 & 3 for, or build on the site, anything other than the buildings shown on the approved drawings and for which planning permission is obtained.
 21. That during the building period, the proposed purchaser will insure the buildings outlined at conditions Nos. 1, 2 & 3 above against fire and all other insurable risks with an appropriate insurance policy and pay all necessary premiums.
 22. That the insurance at condition No. 21 shall be in the name of the proposed purchaser and will be for such an amount as will provide cover for full reinstatement value of so much of the building as is erected at any time together with a sum for Professional Fees and removal of debris charges. The proposed purchaser's financial institution may be a mentioned party on this insurance policy.
 23. That the proposed purchaser and its design team shall indemnify the City Council against any claim for compensation which may be made by any party arising out of building works being carried out on the property outlined at condition Nos. 1, 2 & 3 above, or any working areas or on any access points thereto.
 24. That this agreement is non-assignable or transferable to any other party, save in the case of a Financial Institution which has entered into a mortgage with the proposed purchaser for the purposes of financing development of the site outlined at conditions Nos. 1, 2 & 3, which mortgage must be approved by the City Council in writing, and must have been entered into specifically for the purpose of financing the proposed purchaser to undertake the development of the property outlined at conditions Nos. 1, 2 & 3.

25. That each party shall be responsible for their own VAT and Stamp Duty liabilities arising from this transaction.
26. That in the case of disputes concerning valuation issues in the agreement the Arbitration clause shall refer to the appointment of a Chartered Valuation Surveyor to act as Arbitrator. This person to be appointed by agreement of the parties or in default of agreement to be appointed by the President of the Society of Chartered Surveyors in the Republic of Ireland. The cost of any Arbitration to be borne equally by the parties.
27. That each party shall be responsible for their own professional costs arising in this transaction.

That any of the dates / time frames outlined above may be extended by the Executive Manager at his absolute discretion and all notices must be given in writing.

The disposal shall be subject to any such covenants and conditions as the Law Agent in his discretion shall stipulate.

No agreement enforceable at law is created or intended to be created until an exchange of contracts has taken place.

The above terms shall include any amendments and/or other conditions as are deemed appropriate by Dublin City Council's Law Agent.

Dated 20th December 2016

Declan Wallace
Assistant Chief Executive

N: 734389.930

E: 716521.087

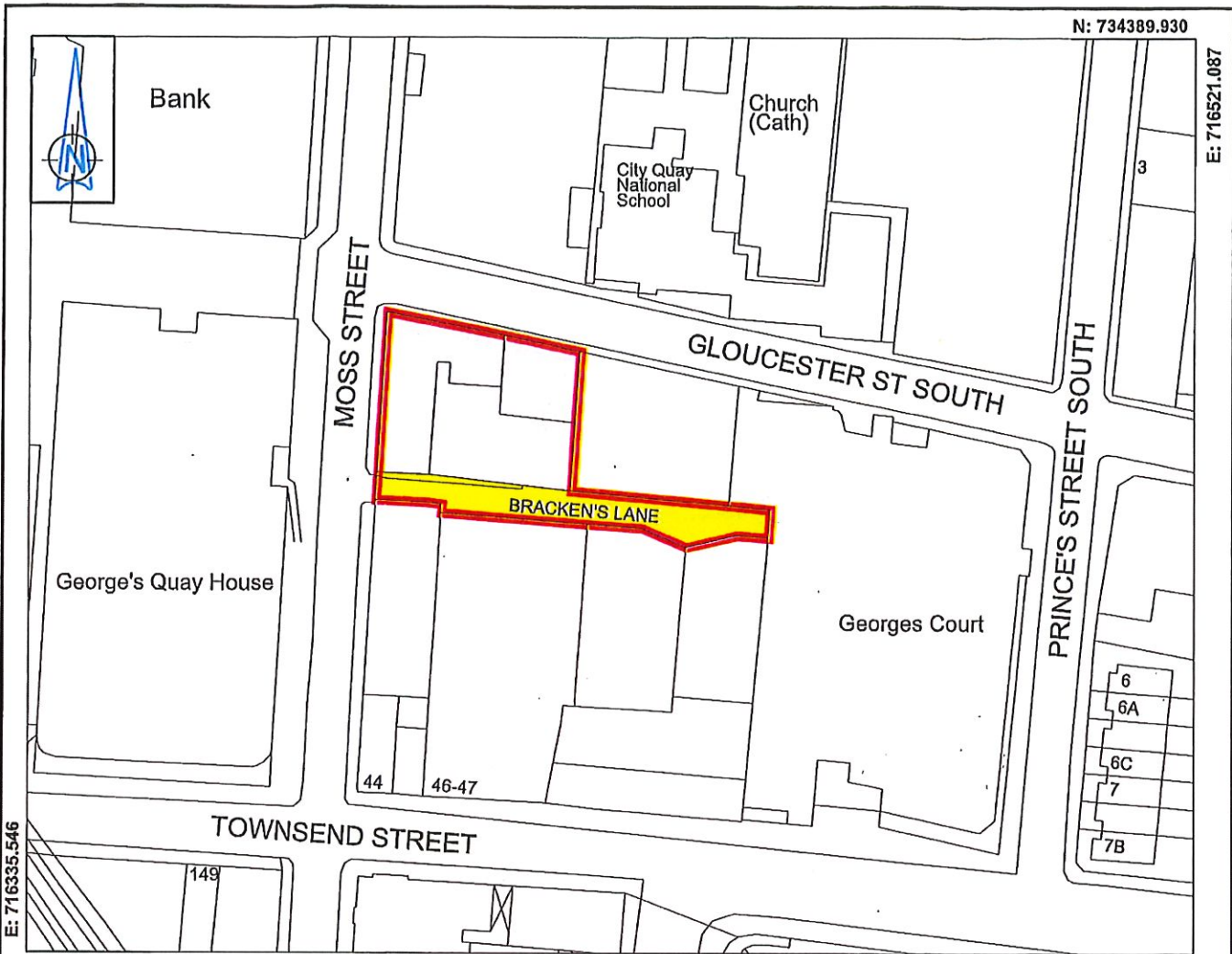

E: 716335.546

N: 734245.962

Lands at Gloucester Street South / Moss Street / Bracken's Lane
 Dublin City Council to Brigante Investments Ltd.
Disposal Map

Total disposal area (1051 SQ m) delineated red thus:
 Right of Way (Area 325 SQ m) shown yellow thus:
 Area (726 SQ m) shown pink thus:



Comhairle Cathrach
 Bhaile Átha Cliath
 Dublin City Council

An Roinn Comhshaoil agus Iompair
Rannán Suirbhéireachta agus Léarscáilthe
 Environment and Transportation Department
 Survey and Mapping Division

O.S REF 3264-01/06	SCALE 1:1000
DATE 23-11-2016	SURVEYED / PRODUCED BY Eoin Ging

INDEX No	FOLDER No	CODE	DWG No	REV
FILE NO	SM-2016-0549-_0204- C3 - 001 - A.dgn			

THIS MAP IS CERTIFIED TO BE COMPUTER GENERATED BY
 DUBLIN CITY COUNCIL FROM ORDNANCE SURVEY DIGITAL MAPBASE
 SURVEY, MAPPING AND RELATED RESEARCH APPROVED

JOHN W. FLANAGAN
 PhD CEng Eur Ing FIEI FICE
ACTING CITY ENGINEER

APPROVED _____
THOMAS CURRAN
 ACTING MANAGER LAND SURVEYING & MAPPING
 DUBLIN CITY COUNCIL

INDEX No.
SM-2016-0549

OSI data : © Ordnance Survey Ireland. All rights reserved. Licence Number 2015 /22/CCMA/ Dublin City Council

Surveyed 1974
Revised 2006
Levelled 1985

George's Quay House

Urban PLACE Map



ITM CENTRE PT COORDS.
718475 734294

DESCRIPTION

MAP SHEETS
1:1000
3284-06



Prepared by: Historic Dublin, Dublin
Revised: November, 2007. Date of
Data Collection: 2007. Survey:
Fluoride V. Dublin

Each of the sheets in this set contains
25,000 square metres (approximately
9,600 square feet) of the city.
Individual sheets are numbered on
the map. The sheets are numbered
1-25.

This map shows the location of the
sites of the buildings shown on the
map. It is not a plan of the
buildings. The map is intended
to show the location of the
sites of the buildings shown on
the map. It is not a plan of the
buildings. The map is intended
to show the location of the
sites of the buildings shown on
the map.

© Survey of Dublin City Council, 2007
to Commission Survey Plans, 2007

Countess Markievicz
25110

Plot Ref. No. 1225895_1.1
Plot Date 07-JUN-2007



Scales- 1:1,000
Scale- 1:1,000

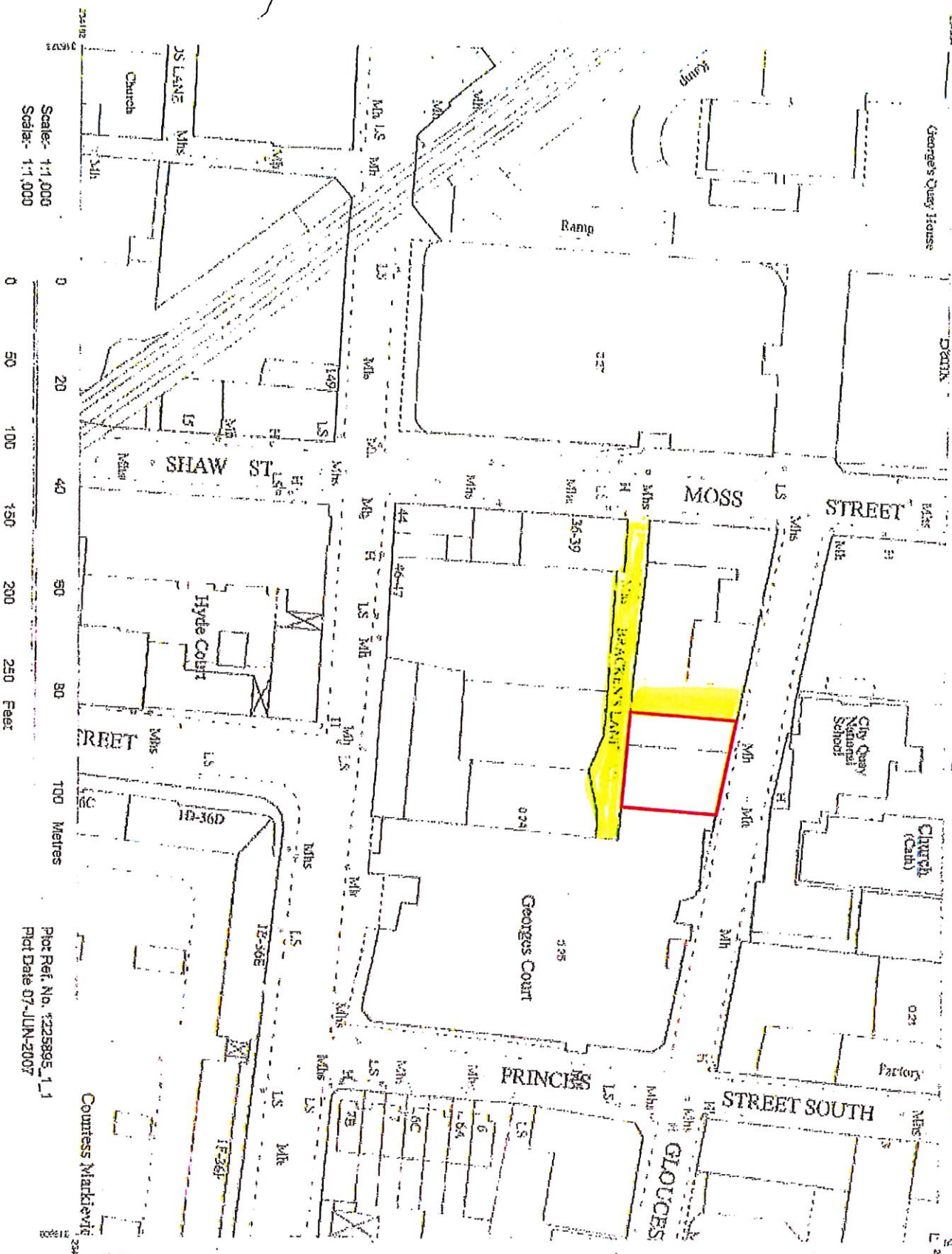

**To the Chairman and Members of the
South East Area Committee**

With reference to the proposed grant of a licence to manage the Pavilion, Tennis Courts and Padel Courts, Bushy Park, Dublin 6 to the Padel Federation of Ireland CLG.

Following an invitation to tender for a licence to manage the pavilion, tennis courts and padel Courts, Bushy Park, Dublin 6, four tenders were received. Based on a qualitative and quantitative evaluation of the tenders received, it is recommended that a licence be granted to the Padel Federation of Ireland CLG to manage the Pavilion, Padel Courts and Tennis Courts, Bushy Park, Dublin 6, for a period of two years. Dublin City Council (DCC) reserves the right to renew the licence for a further two periods of one year each at terms to be agreed.

The proposed Licence shall be subject to terms and conditions and the area is as shown outlined in red on Map Index No. SM2016-0623.

The Licence will be subject to the following terms and conditions:

1. The Licensee will be granted a licence to use the facilities on a non-exclusive basis.
2. The Licence shall be for a period of two years and shall commence on a date to be agreed. The City Council reserves the right to renew the licence for a further two periods of one year each with the agreement of both parties and subject to the total period of the licence not exceeding four years. The Licence, if extended, will be subject to terms and conditions.
3. The Licensee shall pay 30% of the income generated from lettings of the courts to Dublin City Council, which must be lodged to Dublin City Council's account on a monthly basis. After the first year this fee will be subject to review and subject to annual audited accounts being submitted by the licensee.
4. The following will be the responsibility of the Licensee:
 - Nominate a dedicated manager who will act as the main point of contact with the City Council for the duration of the licence. The manager will not change without agreement with the council and shall liaise with a DCC representative bi-monthly or as otherwise agreed
 - Maintain/manage the pavilion, tennis courts and padel courts for the use of playing tennis and padel
 - Open and close the licensed area
 - Monitor and implement the security system attached to the building and will share the keyholding services with Dublin City Council in respect of the alarm system for security purposes
 - Ensure that tennis court/padel courts are nominated and made available on a first come, first play basis to persons/general public who are not participating in coaching or other programmes/leagues at the courts
 - Collect fees in respect of "pay and play" users
 - Provide statistics and information including income and outgoings, relating to the use of the pavilion, tennis courts and padel courts quarterly to the council

- Submit published certified accounts annually to the council
 - Payment of all utilities and services (e.g. ESB, Water, telephone etc)
 - Payment of all necessary brand licence, franchise or other ongoing fees
 - Meet directly all operating costs and expenses involved in the management of the pavilion and courts
 - Compliance with all DCC's security and other policies applying to contractors/suppliers
 - Physical security & insurance of their own equipment and cash
 - All signage to be approved by DCC
 - Make available the use of tennis courts in summer and during certain dates within the three school terms by Dublin Parks Tennis League for the provision of their annual children's tennis coaching programmes. The exact dates/number of courts to be agreed with Dublin City Council and Dublin Parks Tennis League in January each year and notified to the Licensee.
5. Dublin City Council will be responsible for the following:
- Ensuring the fire certificate for the building is in place and providing documentation to the licensee
 - Provision and maintenance of the structure and fabric of the pavilion & courts. This shall exclude the costs of wilful damage or neglect
 - Opening and closing of all the park gates
 - Provision and maintenance of fire alarm and intruder alarm
 - Insurance of building structure.
6. The Licensee must ensure that the toilet facilities are maintained to a good standard and are available to all park users. However, in some circumstances access may be denied to individuals at the discretion of the licensee.
7. The Licensee shall keep the pavilion in good condition and repair, including all fixtures and fittings, including furniture supplied by Dublin City Council during the term of the Licence and shall not remove or permit the removal of any of the above.
8. The Licensee must ensure that no vehicles enter on to the courts at any time without the prior approval in writing of the council, save in the case of emergency and vehicles required for maintenance and repair to the flood lighting.
9. The Licensor will provide the Licensee with a key for the gate and early opening for pavilion /courts is permitted subject to an agreed procedure with Dublin City Council. Similarly, as the courts are floodlit, it is anticipated that the pavilion/courts may be opened beyond normal park closing times and will be subject to an agreed procedure with Dublin City Council.
10. The Licensee shall not at any time:
- i. make any structural change or material alteration or addition of any kind to the pavilion, tennis courts or padel courts save with the prior written agreement of the council, and upon such terms as the council shall specify
 - ii. hang or affix any material on walls save with the written consent of Dublin City Council
 - iii. assign or sublet the premises or any part thereof including fittings and fixtures. It shall not allow any other person to occupy or share occupancy of the pavilion, tennis courts or padel courts, save with the prior written consent of the council and upon such terms as the

council shall specify. Dublin City Council shall have absolute discretion in granting or refusing such permission.

11. On termination of the Licence, the Licensee shall at his own expense remove all items not belonging to the City Council and shall leave the property in a clean and good working condition to the satisfaction of the council.
12. The Licensee undertakes to use the premises only for the purpose stipulated. They will operate the pavilion, tennis courts and padel courts during agreed opening hours and ensure there is sufficient trained staff on duty to provide a quality service at all times. The Licensee will ensure that the highest standards of customer service are provided to the clientele of the facility.
13. The Licensee shall be responsible for appropriate insurances as determined by Dublin City Council, including Public Liability €6.5 million, Product Liability €6.5 million and Employers Liability €13 million and shall indemnify Dublin City Council against all actions, proceedings, costs, claims demands and liabilities whatsoever arising from all and every activity carried out or promoted by the Licensee and its agents in connection with the facilities on the premises. It shall not do or suffer to be done any activity in any part of the premises which would render void or voidable the insurances of the premises. Copies of insurances to be presented to Dublin City Council before commencement of the concession. The fixture and fittings in the pavilion, tennis courts and padel courts will be insured by the council. The contents belonging to the Licensee will not be insured by the council.
14. The Licensee shall permit Dublin City Council, its servants and agents, accompanied by all necessary equipment, to enter the premises giving at least two week's notice in writing of its intention, (except in emergency situations) to carry out any works, without liability to compensate the Licensee for any loss, damage or inconvenience, and do all acts necessary for the purpose of carrying out such works to the premises which the council may think fit and on demand forthwith to remove all such articles out of the premises as may be indicated by the council as requiring removal (vacating the space completely if necessary) in order to enable such works to be more conveniently carried out.
15. The council shall not be liable to compensate the Licensee for any loss, damage or inconvenience as a consequence of the performance of any works by its servants or agents within any part of the premises.
16. The Licensee shall not infringe or permit the infringement of the terms of any Act of the Oireachtas, any regulation made pursuant to the same or any bye-law or regulation of a local or public authority, in or about the use of the pavilion, tennis courts and padel courts.
17. The Licensee shall ensure compliance with all Health & Safety Legislation and regulations made there under. The Concessionaire must submit a copy of an up to date Safety Statement (SS) and Risk Assessment (RA) and must be Site Specific to the pavilion, tennis courts and padel courts, Bushy Park.
18. The Licence agreement may be terminated by either party on giving the other two months notice in writing of its intention.
19. The council shall have no responsibility whatever for the goods and works of the Licensee on the premises.

20. Nothing herein contained is intended to create or shall be taken as creating a relationship of Landlord and Tenant between the Licensor and the Licensee.
21. Each party shall be responsible for their own legal fees.
22. The Parties hereto accept that this Agreement is a Licence Agreement for the use of the premises only and that it does not constitute nor is it intended to constitute a tenancy of any sort in the premises.
23. These terms and conditions and any other terms as deemed necessary by the Law Agent, will be incorporated into a legal agreement which will be prepared by the council's Law Agent and completed by both parties prior to the Licensee entering onto the property.
24. The Licensee shall sign a Deed of Renunciation.

No agreement enforceable at law is created or intended to be created until exchange of contracts has taken place.

Paul Clegg
Executive Manager

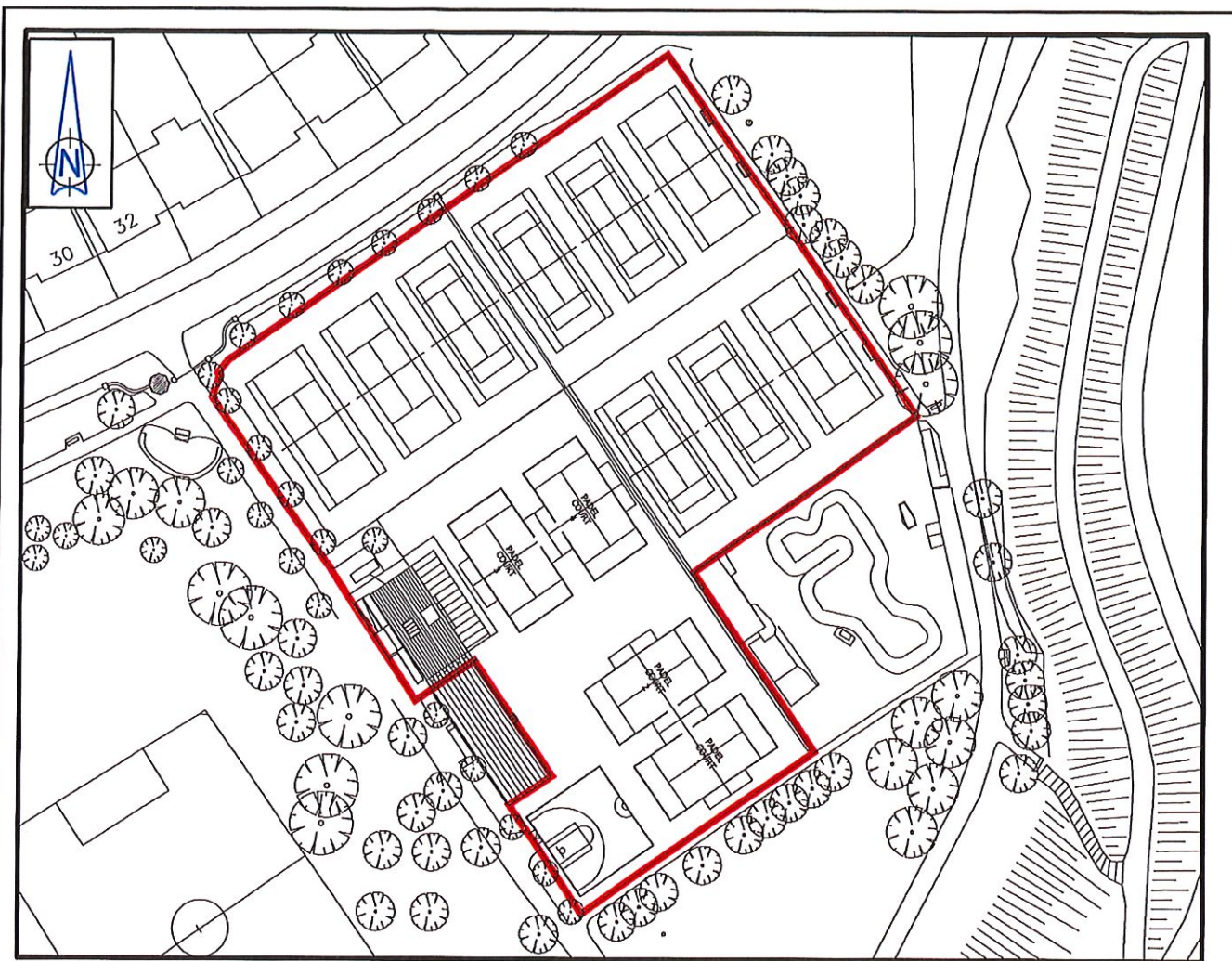

Bushy Park, Dublin 6
Pavilion, Tennis Courts & Padel Courts
 Grant of 2 Year Licence to Padel Federation of Ireland
 Licence Map

Area (7423 SQ m) delineated red thus: ———



Comhairle Cathrach
 Bhaile Átha Cliath
 Dublin City Council

Rannóg na bPárceanna agus Seirbhísí Tirdhreach
Rannán Suirbhéireachta agus Léarscáilithe
 Parks & Landscape Services Division
 Survey and Mapping Division

O.S REF 3328-23	SCALE 1:1000
DATE 13-12-16	SURVEYED / PRODUCED BY E Ging

INDEX No	FOLDER No	CODE	DWG No	REV
FILE NO	SM-2016-0623-_0204- C3 - 001 - A.dgn			

THIS MAP IS CERTIFIED TO BE COMPUTER GENERATED BY
 DUBLIN CITY COUNCIL FROM ORDNANCE SURVEY DIGITAL MAPBASE

SURVEY, MAPPING AND RELATED RESEARCH APPROVED

APPROVED _____
THOMAS CURRAN
 ACTING MANAGER LAND SURVEYING & MAPPING
 DUBLIN CITY COUNCIL

INDEX No.

SM-2016-0623

L. MOORE
 CITY PARKS
 SUPERINTENDENT

OSI data : © Ordnance Survey Ireland. All rights reserved. Licence Number 2015 /22/CCMA/ Dublin City Council

**To the Chairperson and Members of the
South East Area Committee**

Environmental Services Unit Report

Abandoned bikes

64 full bikes and 104 frames were removed in 2016 throughout the South East Area. This operation will continue this year.

Events

- TradFest Temple Bar, 25th to 29th January 2017
-

Housing Projects and Local Area Improvements

Charlemont.

Project remains on target for completion Dec 2017. Next Regeneration Board meeting scheduled for January 25th 2017. Regular meetings are held with the residents or their representatives and the various agencies. The Project Office continues to issue communications to the residents with regard to works on site.

Southern Campshires Flood Protection Scheme

The contractor moved on site on 23rd October 2014. The works are being carried out by the Office of Public Works (OPW) and various sub-contractors and supervised by various consultants for different aspects of these works. A number of ground condition problems have slowed this project down to date. The estimated cost of this whole project from Butt Bridge to Cardiff Lane is €3.5m and is around 75% completed. Georges Quay is reopened except for trees to be installed later. One third of flood gates will be installed before Christmas. Substantial completion will be around March 2017 except for some minor contracts on works.

Grand Canal Sub Group

The latest meeting of the Grand Canal Sub-committee was held on 9th November 2016. Ms. Terre Duffy, WI Dublin Docklands Development Manager and her colleague Benny Cullen attended. Presentation was made by Michael Coffey and Martin Laffan of TÚS Project also. The next meeting of the Grand Canal Sub-committee will be held on Wed 11th January 2017.

Rathgar Village Improvement Plan (VIP)

The finalised Rathgar Village Improvement Plan (VIP) was approved at the January 2015 South East Area Committee. New lamp standards have been installed. New pedestrian crossing will be in place in 2016. REDscape, Landscape Architects, were appointed to design a plan for Herzog Park. The Draft Landscape Masterplan was open to informal public comment until Friday 8th April 2016. 27 submissions were received. Pre Part 8 went before the SEAC on 11th July and Part 8 Planning Application was approved by Planning Department and noted at the December 2016 South East Area Committee meeting. The recommendation is due to go before the meeting of the full City Council on 9th January 2017

for approval. The contract for the Pedestrian Crossing has been awarded and works are due to commence early in 2017.

Ranelagh Gardens Park

The Part 8 was approved at the City Council meeting on Monday 6th July 2015. The tender for the playground has now been awarded and works are due to commence on 9th January 2017. Other elements of the Part 8 will be provided in 2017 subject to finance.

Ringsend Irishtown Local Environment Improvement Plan (LEIP)

Consultation commenced in January 2016, beginning with meetings with local business groups and others, followed by an open morning in Ringsend Library on Thursday 28th January 2016. Following tender process Mitchell and Associates were appointed to deliver the Local Environment Improvement Plan in March 2016. Initial internal consultations with relevant Dublin City Council departments and Mitchell and Associates took place during March and April 2016. A draft presentation of the plan was presented at a public workshop was in Ringsend Irishtown Community Centre on the 8th June 2016 to further canvass the views of local residents, businesses, community groups and other stakeholders. Proposals were refined by Mitchell and Associates based on comments received at the workshop and subsequently. A series of meetings took place in October and November with works departments and further public workshop was held on 7th December 2016 where a revised draft plan was presented and further comments taken. A draft Ringsend Irishtown Local Environment Improvement Plan will be displayed on the Dublin City Council Website and in Ringsend Library / Ringsend Irishtown Community Centre for a period of four weeks in early January 2017 during which time further comments and submissions can be sent to southeast@dublincity.ie or South East Area Office, Dublin City Council, Block 2, Floor 4, Civic Offices, Dublin 8. Following that the plan as amended will be brought to the South East Area Committee of Dublin City Council for adoption early in 2017.

Terenure 2030

In 2016 6 no. new lamp standards were provided in the village along with cycle parking and new litter bins. Village greening projects were ongoing in 2016 as part of Vibrant Villages. Further support will be provided in 2017 subject to finance.

To the Chairperson and Members of the
South East Area Committee

Dublin City Sports and Wellbeing Partnership Report

- The 2017 **Lord Mayor's 5 Alive Challenge** kicked off on New Year's Day in the Phoenix Park with the Liffey Valley Tom Brennan Memorial 5K. The five race series is proving as popular as ever with the maximum 450 entrants signing up within an hour of registration opening. The challenge runs from January to April and more details can be found at: www.dublincity.ie/lord-mayor-5-alive-challenge-2017
- **Sports & Fitness Markievicz** finally reopened its doors to the public on Monday 19th December 2016. The fully qualified staff can advise, support, motivate and encourage clients to set simple and attainable goals that will ultimately lead to improving their overall health & wellbeing.

The competitively priced annual membership includes group fitness classes, assessments and full use of the pool, gym & new sauna/steam room. Also on offer are top class swimming lessons for both children and adults. You can find more information on swimming lessons by contacting gareth.matthews@dublincity.ie

The manager of the facility, Aideen O'Connor, would like to take the opportunity to thank everyone for their understanding and support throughout the past year and would be delighted to show anyone around the facility. Further information on membership or for any other queries please contact Eoin Gallagher, Duty Manager (eoin.gallagher@dublincity.ie) or email sports&fitness.markievicz@dublincity.ie

- **Change For Life**
Change for Life is taking place in Harold's Cross in partnership with the local Home School Liaison Teacher. Participants will receive an assessment, a weekly weigh-in & classes (including nutritional talk and organised walks). The programme will run for 8 weeks in line with the Operation Transformation TV show and all participants will be re-assessed at the end.
- **Jumping Jacks**
This is an initiative designed for young children to teach them fundamental movements skills through fun & games to help participate in activity throughout their life. The Programme will take place in Harold's Cross NS after classes have finished.
- **Chair Fit**
Chair Fit classes will take place in Sandymont with the Iris Charles Centre for older adults every Tuesday at 11.30am. This class will help to increase the mobility and flexibility of the participants, improving their overall general health.

- **Yoga**
Yoga classes will take place every Tuesday from 10.30am -11.30am in the Lantern Centre, Synge Street for multi-national women. The class will take place every second Tuesday and will continue for 8 weeks.
- **Irishtown Meet & Train**
The Irishtown Meet and Train sessions will resume on Tuesday mornings from the 20th January. The walk will start at 10.15am from Irishtown Stadium. This is open to men and women in the area.
- **Sprog Soccer:** This initiative for 4 – 8 year olds takes place every Friday morning in Sports & Fitness Irishtown (currently 60 participants) and every Wednesday at 9.30am in YMCA Aungier St (currently 40 participants).
- **Girl's Soccer:** Ongoing every Tuesday & Thursday evenings in Ringsend Park. Will recommence in mid January after the Christmas break. Please contact the local Football Development Officer for more information.
- **Men's League:** Ongoing every Monday & Wednesday evenings from 6pm to 8pm in Ringsend Park.
- **Club Development Programme:** The local Football Development Officer will be running a Child Welfare Courses on January 16th in Irishtown Stadium for local clubs in the Dublin 2/4/8 areas.

'Kick Start 1' Courses are also planned for January 27th/28th & February 4th/5th.

- The **Cricket** Development Officer is currently liaising with Sports Officers in the area to co-ordinate programmes for the New Year.

Provincial cricket sessions will continue on Friday nights from 5pm – 9.30pm. These are held in the North County Cricket Club where a number of players from the South East Area are involved. Players are between 10-18 years of age.

The Cricket Development Officer will be delivering school yard sessions in the following schools during the next quarter (days/times TBC):
Star of the Sea Primary School

St. Matthew's National School
Synge Street CBS
Ranelagh Multi Denominational School

Contact details

Antonia Martin, DCSWP Manager: antonia.martin@dublincity.ie

Michelle Malone, Sports Officer: michelle.malone@dublincity.ie

John Sweeney, Sports Officer: john.sweeney@dublincity.ie

Aideen O'Connor, Sports & Fitness Markievicz & Irishtown: aideen.oconnor@dublincity.ie

Football: jonathan.tormey@fai.ie

Rugby: ken.knaggs@leinsterrugby.ie

Boxing: michael.carruth@dublincity.ie

Cricket: fintan.mcallister@cricketleinster.ie

Report by:

Alan Morrin, Staff Officer, Dublin City Sport & Wellbeing Partnership.

**To The Chairperson and Members of the
South East Area Committee**

**With reference to a proposal to extinguish the Public Right of Way at
Stable Lane, off Harcourt Street, Dublin 2.**

An application to have the public right of way extinguished at Stable Lane, off Harcourt Street, Dublin 2, was received on behalf of the majority of the owners whose property is abutting or has access to the lane. The reason for the proposed extinguishment is to eliminate anti-social behaviour in the laneway and to facilitate a safer environment for those who live here and for those who legitimately use this laneway.

The extent of the proposal is shown on the attached map ref. No. R.M. 36563 dated 24th March 2016. The laneway is under the charge of Dublin City Council. The laneway is not a through-way and suffers from poor passive surveillance.

The South East Area Committee, at its meeting on 13th October 2016 agreed to initiate the statutory procedures to extinguish the public right of way at this location under the provisions of Section 73 of the Roads Act 1993.

Service Check

A service check was carried out. Virgin Media, Gas Networks Ireland and E.S.B. Networks have no objections but have stipulated that access will have to be maintained. Eircom Limited, Trading as "open eir", has no objections but has stipulated that open eir's access and legal rights to the underground telecommunications plant in the lane are to be maintained and respected. Road Maintenance Services, Road Design, Traffic Management & Control, Property Registration, Public Lighting & Electrical Services have no objections. To date no requirements have been stipulated by Water Services. However, access will be available to them as required.

Consultation has taken place with Dublin Fire Brigade and the applicants have confirmed that the requirements of the Fire Officer in relation to the proposal will be met. The applicants have also contacted the Planning and Property Development Department in relation to plans and elevations for the proposed gate at the entrance to the laneway and the relevant requirements will be complied with.

Statutory Requirement

By public advertisement in the Irish Times on 17th October, representations or objections were invited by the 2nd December 2016. Site notices were erected on Stable Lane on 17th October 2016 for a period in excess of 14 days.

One submission was received on the 24th November 2016 from A & L Goodbody on behalf of its client IPUT Plc in relation to the proposal. Clarification was sought in relation to a number of issues including ownership of the laneway, access rights, storage of bins, disputes that may arise post the extinguishment process and how services will be paid for if parties refuse to contribute. The letter stated that IPUT Plc was objecting to the proposed extinguishment of the public right of way until such time as it received comprehensive replies to the points raised. A comprehensive reply was issued to A&L Goodbody by Dublin City

Council's Law Agent on the 25th November 2016 and no further correspondence was received by the closing date, 2nd December 2016.

Recommendation

I have considered the issues raised by A & L Goodbody on behalf of its client IPUT Plc. A comprehensive reply was sent by the Law Agent in relation to the issues raised and no further correspondence was received by the closing date 2nd December.

Stable Lane is not a through-way and suffers from poor passive surveillance. An Garda Síochána, Pearse Street, are supportive of the proposal as the area is prone to regular anti-social behaviour and criminal activity. The laneway is routinely littered with needles and other drug paraphernalia along with human waste. The Community of the Holy Child reside on Stable Lane and their home has been broken into on a number of occasions.

Should the laneway be gated, access will be provided via a keypad operated lock on the gate. The gates will also be manned by an intercom system 24/7 with CCTV cameras linked to the reception desk in the nearby Harcourt Hotel, so that access can be maintained at all times. The applicants have undertaken that a Management Company will be set up representing the majority of the owners mentioned above and this Management Company will cover public liability and all other issues that may arise on the laneway post extinguishment in respect of all of the owners whose property is abutting or has access to the lane.

I am satisfied that the gating of the laneway is the best solution to eliminate the anti-social behaviour in this area and to facilitate a safer environment for those who live here and for those who legitimately use this laneway.

I accordingly recommend that the Committee recommend to the City Council that the extinguishment of the public right of way over the area indicated on Drawing No. R.M. 36563 be approved subject to the requirements of the Fire Officer and the Planning Department in relation to the design of the gate. In addition, the laneway shall not be used by the adjoining property owners or others for unauthorised use.

The extinguishment of a public right of way is a function reserved to the City Council.

Rose Kenny
Area Manager

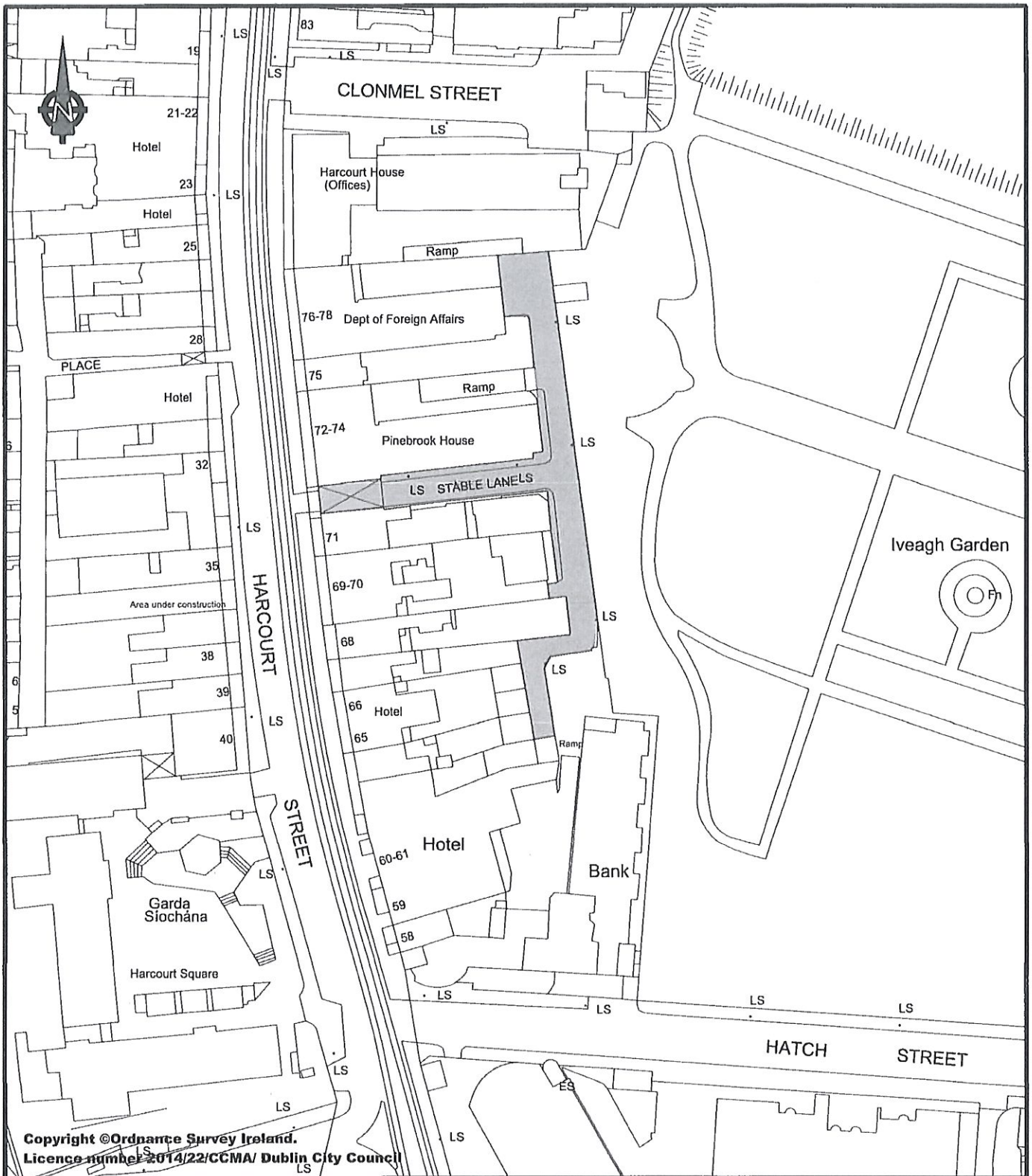

Copyright © Ordnance Survey Ireland.
Licence number 2014/22/CCMA/ Dublin City Council



DUBLIN CITY COUNCIL

Cornhairle Chathair Bhaile Átha Cliath

ENVIRONMENT & TRANSPORTATION DEPARTMENT,

CIVIC OFFICES,

WOOD QUAY, DUBLIN 8.

John Flanagan
EXECUTIVE MANAGER (ENGINEERING)

Roads Act 1993 Section 73 (1).

Proposed extinguishment of public r.o.w.

over 'Stable Lane' at rear of nos

64-78 Harcourt Street as shown.

ROADS MAINTENANCE DIVISION

R.M. 36563

C.A.D. BY	DATE	REVISED	SCALE
r.j.h.	24032016	//20	1:1250

Motions

Motion 1 from Councillor Dermot Lacey

This committee agrees to initiate a process that could lead to an agreed community bonfire in Ringsend for Halloween.

Motion 2 from Councillor Paddy Smyth

That this committee write to the fast food vendors in Rathmines Village requesting that they ensure that their customers dispose of their rubbish responsibly and / or provide a staff member to routinely survey the area to pick up and dispose of any rubbish which originated from their premises.

Motion 3 from Councillor Dermot Lacey

This committee requests the manager to have a wheelchair accessibility audit conducted along the footpaths in the general Ringsend village area.

Motion 4 from Councillor Claire Byrne

That this area committee requests the area manager to carry out another traffic survey on St. Kevin's Road, Portobello. The last survey was carried out in August when school and commuter traffic is lower than usual and therefore the results could not be reflective of the actual level of rat running and speeding that takes place on this street. In addition, can the area manager also confirm whether the planters that have been put in place as a traffic calming measure will remain as a permanent feature?

Motion 5 from Councillor Claire Byrne

That this area committee calls on the area manager to address the on-going issue of illegal dumping and litter on South Dock Road as a matter of urgency. The residents have been in touch with Litter Enforcement and Fix My Street on a number of occasions but the problem has not yet been resolved.

Motion 6 from Councillor Mary Freehill

That the DYL be urgently replaced on Garville Lane which is the rear of 72 Garville Avenue. I have tabled a number of motions regarding this area because the residents have major problems in accessing their garages due to commuter parking on the lane. In this instance the resident of 72 Garville Avenue is an elderly woman and uses a wheelchair. There are steps at the front entrance so she needs the rear which is all flat to access her home. Because of the access issues involved I ask that this proposal be treated as urgent.

Motion 7 from Councillor Mary Freehill

A new residents' association called Corrib Road Mount Tallant has been formed and this takes in all the houses from Kimmage Road, Aideen Drive to Mount Tallant Harold's Cross Road. Over 20 years ago to deal with very serious rat running a number of bollards were placed on some roads. Because rat runners are now able to negotiate their way around this maize, the bollards are no longer effective.

There is a problem at right turn into Aideen Drive from Kimmage Road, which has a no right turn there from 8.0.am. to 10.00. There is no compliance and this needs to be policed. This is not the only entry into this area and a traffic study needs to be carried out for the area.

1. This is a route to six schools, St. Joseph's NS &, Presentation Secondary, Terenure, Rathgar NS Rathgar Avenue, Clareville Road., 2 schools and St Clare's Harold's Cross. Traffic is very considerably lighter during school holidays. These roads are like a static car park from 8 to 10.00a.m, moving east, and moving west from 12.30 to 4p.m. and 5.p.m. to 6.30.

2. The central bollard was removed on Corrib and Melvin Road, the result of this is that cyclists and motor bikes move to middle of road to pass through the bollard and stay in the middle road passing a three road junction. This is extremely dangerous and apparently there is a plan to remove a bollard from Derravarragh Road, Neagh Road and Mount Tallant Avenue. Recently an Engineer's report stated that these roads don't need yield or stop signs. I witnessed just how dangerous this junction and it needs to be inspected.
3. Residents from Aideen Place park on the footpath on Aideen Drive, because of heavy morning traffic they cannot exit their lane, and this is causing problems on Aideen Drive.
4. At Harold's Cross end of Mount Tallant Avenue, Woodworkers Builders suppliers attract a lot of heavy delivery trucks which causes a lot of traffic chaos. Also there is a planning for 72 apartments so this road urgently needs to be assessed.

Therefore it is agreed that an on-site meeting takes place with the residents' association please, preferably after 2.0p.m. but during school term. I really think this area has to be seen to understand the difficulties. I am therefore formally proposing that an Area Traffic Study be carried out. As this problem is also very much connected with Clareville Road as per my December motion and I think the whole area may need to be examined. Ms Murphy Chair of the Association first wrote to you in October 2015 and got no reply she wrote again 3 weeks ago and no reply. I make this point as they should be well up the queue by now.

Motion 8 from Councillor Sonya Stapleton

This committee calls on the manager to contact the Carmelites' Community Centre to intervene and discuss their intentions on closing down the community crèche with their view to turning it into a private crèche. This crèche is badly needed by local constituents and the Carmelites' proposal to privatise it would be too expensive for people and push them out of employment and training opportunities. There will also be job losses in the crèche if this is allowed to go ahead.

Motion 9 from Councillor Sonya Stapleton

This council calls on the manager to provide funding/grant/ to help compadrito Tango. They are a community- based volunteers tango dancing group that hold classes for the community in Dublin 2 on a weekly basis. They are having a festival in July 2017. Unfortunately, the only funding they have is through donations. Funding is needed for the cost of the festival, rental, artists' fees, accommodation, catering and flights etc. Contact Simona Zaino, <http://tangofever.net>

Motion 10 from Councillor Sonya Stapleton

This council asks that a location can be identified in the Dublin 2 or surrounding areas for constituents that have a love for playing cricket. I have been approached by a group of men that have told me there is nowhere to play their sport. The only option they have is to join a cricket group which is very costly. They have tried to play in various locations, Phoenix Park, Stephen's Green etc... However, they were stopped on all occasions by park wardens.

Motion 11 from Councillor Mary Freehill

That this meeting receives an update on negotiations with Irish Water on the status of piping on Adrian Avenue numbers 17 – 20. Furthermore if taking in charge of the interior end of Aideen Drive is necessary to facilitate them having their public piping renewed that this be done.

Motion 12 from Councillor Frank Kennedy

This committee thanks Iarnród Éireann for the clean-up conducted at the area surrounding the footbridge over the Dart line between the Merrion Gates and Sydney Parade Avenue (which is the bridge from behind Ailesbury Mews and the OSG office building into Merrion Parish Church), and in particular at the footpath and surrounding area between the railway line and the OSG building / Ailesbury Mews following the motion passed at the November meeting of the SEAC. However, notwithstanding the considerable improvement, a significant portion of the original rubbish remains, with the area under the footbridge remaining the most acutely affected. Regrettably, the area remains generally dirty and unhygienic and there is still a lot of litter and bottles scattered around and gives the impression of being a dumping ground which cultivates the accumulation of further waste. In circumstances where one further effort will significantly enhance the area and maximise the return on the works which have been carried out to date, this committee requests that Iarnród Éireann completes this job and resolves to write to Iarnród Éireann to so request.

Motion 13 from Councillor Chris Andrews

That this area committee supports the actions of all those volunteers and those supporting the Home Sweet Home initiative, who have occupied Apollo House since the night of Thursday 15th December in order to address the worsening homeless crisis in Dublin and across the country and furthermore we call on Minister Coveney to meet with organisers on site in order to see what can be done when real commitment is shown to ending the homeless crisis and request the Minister / Dublin City Council put in place funding to increase the capacity of homeless in Apollo House.

Motion 14 from Councillor Claire Byrne

That this Area Committee asks the Area Manager to increase the level of leaf removal and gully cleaning on Bloomfield Avenue, Portobello Dublin 8. This street is tree lined and has significant leaf fall which also clogs the gullies. Every year the residents have to make complaints in order for this street to be addressed.

Motion 15 from Councillor Claire Byrne

That this Area Committee rejects the proposals to remove bins on Bride Street and Grantham Street, and the general practice of removal of bins as a solution to illegal dumping, asks that these bins be replaced as a matter of urgency and calls on the Area Manager to seek alternative methods of addressing the on-going problems of illegal dumping in the South East Area.

Motion 16 from Councillor Claire Byrne

That this Area Committee supports the Home Sweet Home initiative as it highlights NAMA's failure to deliver on its social dividend and to address the housing crisis in Dublin City.

Q.1 Councillor Dermot Lacey

To ask the Manager if she will arrange to have the area known as "The Drain" alongside Ringsend Park included in the weekly sweeping plan and have the same area examined for resurfacing.

Q.2 Councillor Dermot Lacey

To ask the Traffic Advisory Group to look at the possibility of installing a roundabout at the junction of Newbridge Avenue / Tritonville Road instead of the present confusing arrangements.

Q.3 Councillor Dermot Lacey

Further to question number 44 at the December area committee tabled by Councillor Paddy McCartan and bearing in mind that the specific question related to the fact that the site height at Dunluce is now between 300 - 700mm above the garden levels of neighbouring houses and that on the original drawing, which were submitted as part of the grant of planning, the site height was below neighbouring properties. This raises concerns for neighbours with surface water potentially draining into their properties from Dunluce.

The bigger issue raised is whether the actual building is now 700mm higher relative to other properties than the original grant of planning?

Can the manager respond to this?

Q.4 Councillor Dermot Lacey

To ask the manager if she can take action to have the serious rat problem to the rear of *details supplied investigated and dealt with through liaison of whatever state agency has responsibility, if not Dublin City Council.

Q.5 Councillor Chris Andrews

Will the manager agree to have a school lollipop person located at the junction of Hanover Street East and Creighton Street given the increased number of children using this point to get to city quay school along with the increased developments in the area that will dramatically increase the number of cars using this junction?

Q.6 Councillor Chris Andrews

Will the manager have the zebra crossing on Hanover Street East moved closer to junction with Creighton street and past the closest gate from Pearse House and close to Creighton Street when the development is complete, as a lot of children use that gate to go to school and will not walk back to use the crossing particularly when the Euro Spar is moved closer to Creighton Street?

Q.7 Councillor Chris Andrews

Can the manager state how many cars have been clamped in Pearse House in 2016 and can a letter be sent around the residents in Pearse House to let them know the requirements re parking and visitors parking passes?

Q.8 Councillor Chris Andrews

Can the manager have the maintenance issue in *details supplied fixed as a matter of urgency as water comes down the internal wall every time it rains and this has been going on for the last few years without it ever being properly fixed and the smell

this causes from water rotting the floor is making it worse so can contractors be hired to fix this long running problem?

Q.9 Councillor Chris Andrews

Given that the bridge in Ringsend is particularly unsafe for pedestrians and that there are proposals/plans for the upgrading of the bridge why works cannot commence to make the bridge safer ahead of the Greenway project?

Q.10 Councillor Paddy McCartan

To ask the manager to examine the possibility of providing a pedestrian crossing at Park Avenue, Sandymount adjacent to the number 1 bus terminus. Recently a constituent was knocked down as she attempted to cross the road on alighting from the number 1 bus. As there is a church and also a nursing home in close proximity this is now a safety issue and needs to be addressed.

Q.11 Councillor Paddy McCartan

On Mespil Road, off Baggot Street Lower, office staff of adjoining premises smoke outside on the street and there are no bins provided for the disposal of butts. Thus the pavements are covered in cigarette butts. Has Dublin City Council (DCC) any role in ensuring companies provide bins and comply with the litter laws? Can DCC provide bins on that stretch of Mespil Road?

Q.12 Councillor Paddy McCartan

Can the manager clarify who is responsible in the situation outlined in the following: There are tall trees in the grounds of the Dublin Institute for Advanced Studies (DIAS), Burlington Road, which are never pruned or maintained? They encroach on Waterloo Lane and branches fall on driveways. There has been no response to the issue following written requests from residents to deal with the problem. As this is a health and safety issue, has Dublin City Council any power to intervene?

Q.13 Councillor Paddy McCartan

To ask the manager to deal with this issue on Erne Street Lower / Hanover Street East, as in the following photograph and email from a constituent:

"This morning I was cycling into work and I was coming down Erne Street Lower, taking a right turn on to Hanover Street East when I came off my bike. I was travelling at a reasonable speed. When taking the right turn the wheels on my bike slipped on the cobbles. My wrist is a bit sprained and I took a bang to the head; however, the helmet protected me from most of the impact.

It did leave me to wonder why on earth is there a square of cobbles in the middle of a junction for four tarmaced roads. Given the extent of the traffic on this road and how slippery the cobbles seemed this morning, I would think it in the interest to public safety that the junction surface be replaced with something less hazardous. I've attached a picture of the junction to demonstrate"



- Q.14 Councillor Paddy McCartan**
To ask the manager to deal with the issue of overflowing, unemptied bins left out on the pavement 24/7 at Sussex Road (the stretch between the Canal Bank Café and the Burlington Hotel).
- Q.15 Councillor Paddy McCartan**
There is an abandoned car at Sussex Road with an out of date tax disc and no insurance. It has a legal parking permit, but the vehicle is registered at a different address.
- Q.16 Councillor Paddy McCartan**
To ask the manager to examine the feasibility of installing traffic calming from the corner of Upper Leeson Street and onto Sussex Road, as vehicles fly around the corner at dangerous speeds. Traffic calming is needed from Leeson Street Bridge as far as the Burlington Hotel.
- Q.17 Councillor Claire O'Connor**
Could the manager arrange for double yellow lines to be put down parallel to the river in Mount Argus Court in circumstances where lorries and cars are parking parallel to the river making the entrance to Mount Argus Court tight and hazardous for residents?
- Q.18 Councillor Claire O'Connor**
Could the manager arrange for the footpath outside *details supplied to be repaired?
- Q.19 Councillor Claire O'Connor**
To ask the manager if the road markings to indicate 'NO ENTRY' can be repainted in Castlewood Park in circumstances where they have deteriorated and are now practically illegible, with a consequent effect on road safety in Castlewood Park.
- Q.20 Councillor Claire O'Connor**
Can the park furniture, bridge railings etc. be repainted in Mount Argus Park?
- Q.21 Councillor Claire O'Connor**
Can Lower Beechwood Avenue be cleaned?
- Q.22 Councillor Claire O'Connor**
Can a sign be erected at the entrance to Saint Kevin's Park in Dartry to indicate that children are at play?
- Q.23 Councillor Claire O'Connor**
Can the potholes outside the front of 73 Garville Ave Upper be repaired?
- Q.24 Councillor Claire O'Connor**
Due to parking, generally by patrons of Bushy Park, in a manner that significantly encroaches on the entrance gates to houses at Rathdown Drive, and prevents residents exiting or exiting safely and readily, can double yellow lines - no more than 1 metre long – be put down at each side of the dished footpath area?
- Q.25 Councillor Claire O'Connor**
Would the manager consider putting more bins for dog waste on Ashdale Gardens as it is littered with dog foul to an appalling level?

Q.26 Councillor Claire O'Connor

Given the heavy footfall in and out of the hospital can Oaklands Drive and Crescent be cleaned more frequently?

Q.27 Councillor Anne Feeney

To ask the manager to see what can be done to address the constant build up of rubbish in Leinster Square from nearby fast food outlets. Residents are now starting to see rats in the area.

Q.28 Councillor Anne Feeney

To ask the manager or Traffic Department to investigate the possibility of putting a right turn light on Harold's Cross Bridge as you approach from the canal and are travelling towards Harold's Cross. It has been brought to my attention that there have been a few near accidents as a result of no filter light.

Q.29 Councillor Mary Freehill

Would the manager please respond to the substance of the motion tabled in December 2014 regarding large trucks in inner suburbs and danger to cyclists? The response below does not address this issue in the motion. While Respect is not explained, I expect this is about behaviour which does not address 5 axel trucks in our suburban roads.

Motion from Councillor Mary Freehill LAC December 2014

That the traffic engineers examine the safety implications for pedestrians and cyclists of very large delivery trucks moving around the inner suburbs of Dublin 4 and 6 and report back to this committee within the next 3 months. The recent tragic accidents Terenure and Ranelagh highlight the potential danger for pedestrians in the area.

The Area Engineers response is below:

"The behavioural change of both drivers and cyclists is an ongoing challenge for Dublin City Council to improve awareness and increased safety for all road users. Dublin City Council continues to promote sustainable transport by continually investing in cycle facilities to encourage cycling in a safer manner.

Dublin City Council's Road Safety Strategy 2016 – 2020 is currently being finalised. A key element to the Strategy under the education pillar will be a public awareness campaign 'RESPECT'. The 'RESPECT' campaign aims to educate and reinforce strong safety messages for all road users, including messaging to cyclists about rules of the road. The 'RESPECT' campaign is due to roll out in early 2017.

The operator of Coca-Cola Zero Dublin bikes has been contacted with regard to the proposal to initiate a public awareness campaign with regard to cycling in the city and will be communicated to members to coincide with commencement of similar safe cycling initiatives by Dublin City Council.

Recently Dublin City Council has carried out Public Consultation on proposed Special Speed Limit Bye-Laws, with particular regard to the extension of the 30km/h speed limit into further residential areas of our city. The proposed expansion of the 30 km/h zone is to ensure that the set speed limits are as safe and appropriate as possible for vulnerable road users, including pedestrians and cyclists.

Under the 'Smart Dublin' initiative, Dublin City Council and Enterprise Ireland announced funding on Thursday 15th September to improve cycling in Dublin by supporting five smart projects using innovative technologies to solve city challenges which will improve the cycling experience and safety of bicycle users in urban areas. Smart Dublin is an initiative of the four Dublin Local Authorities to engage with smart technology providers, researchers and citizens to solve city challenges and improve city life.

Dublin City Council operates a Heavy Goods Vehicles Management Strategy for the city to encourage maximum use of the Port Tunnel by port-related traffic and to enhance the city centre environment. The HGV Strategy provides for a ban on 5+ axle vehicles during the hours of 07.00-19.00 seven days a week from a designated cordon area and provides a limited permit scheme for 5+ axle vehicles that need to load/unload within the city centre area. The HGV Strategy has resulted in dramatic reductions of 5+ axle vehicles within the city centre area of between 80 - 94% on different routes within the cordon area.

Please accept my apologies for the delay in reverting to you on this which was due to staff shortages coupled with a large volume of correspondence to be worked through.

Q.30 Councillor Sonya Stapleton

To ask the manager to have lights fixed in the tower of O'Carroll Villas flat complex. Block beside O'Callaghan's Hotel.

Q.31 Councillor Frank Kennedy

On 15 November 2016 a resident e-mailed Road Maintenance with the following query:

"This morning I was cycling into work and I was coming down Erne Street Lower, taking a right turn on to Hannover Street East when I came off my bike. I was travelling at a reasonable speed. When taking the right turn the wheels on my bike slipped on the cobbles. My wrist is a bit sprained and I took a bang to the head; however, the helmet protected me from most of the impact.

It did leave me to wonder why on earth is there a square of cobbles in the middle of a junction for four tarmaced roads. Given the extent of the traffic on this road and how slippery the cobbles seemed this morning, I would think it in the interest of public safety that the junction surface be replaced with something less hazardous. I've attached a picture of the junction to demonstrate." (Photo attached)

The resident contacted me at the end of the month when he had not received a response.

To ask the Area Manager:

- (a) To provide a response to this query; and
- (b) To explain why the resident received no response to his query.

Q.32 Councillor Frank Kennedy

As one emerges from the entrance to the Grove House apartment complex onto Milltown Road the line of vision in respect of oncoming traffic is extremely poor. Double yellow lines are required alongside the stretch of Milltown Road near this

exit/the adjacent bus stop in order to ensure the safety of all road users. To ask the Area Manager to implement appropriate double yellow lines at this location.

Q.33 Councillor Frank Kennedy

To ask the Area Manager to request that both Derelict Sites and Dangerous Buildings, as well as any other relevant council department investigate the status of the property at [details supplied] and require that appropriate remedial steps be taken in circumstances where the local residents' association reports as follows: *"The house had been unoccupied for about 8 years and is of great concern to nearby residents, particularly the adjoining house (no 95). No 96 is not heated and is causing dampness in No 95. There is also a problem with rats... There is also the risk of squatters."*

Q.34 Councillor Frank Kennedy

To ask the Area Manager to install a pedestrian crossing at the top of Sandymount Avenue at the T-junction of Sandymount Avenue with Gilford Road. This crossing is used on a daily basis by large numbers of schoolchildren.

Q.35 Councillor Frank Kennedy

During the course of the recent footpath repair works on Ailesbury Park, the cement/surface material has set in such a way that the residents of *details supplied cannot open or close the gate which they rely upon for deliveries, bring in and out the bins, pedestrian access etc. To ask the Manager to resolve this without delay in circumstances where it has been caused entirely by the acts of the Council.

Q.36 Councillor Chris Andrews

Can the manager organise for the traffic engineer call out to the principal of the Star of The Sea BNS to examine and consult with the school to address the traffic problem that has developed on Leahy Terrace outside the school particularly at drop off / pick up time there is severe congestion. I am concerned for the health and safety of pupils at these times and feel action is urgently required

Q.37 Councillor Chris Andrews

Will the manager have the patio slabs to the rear and side of *details supplied repaired as they are dangerous and have been lifted as a result of the trees in the Park growing in under the resident's garden.

Q.38 Councillor Claire Byrne

To ask the Area Manager how many staff are dedicated to street cleaning, leaf removal and gully cleaning in the South East Area and how these compare to staffing levels in the same sections prior to 2008.

Q.39 Councillor Claire Byrne

To ask the Area Manager how many complaints have been received by the council from tenants or occupants of council housing in relation to damp, condensation, and / or mould in their residences in the last 3 years, the details of the investigations that have been carried out in response to such complaints, the number of units which underwent each type of investigation, how many of these complaints led to action being taken, what action was taken to remedy the problem, how many units were remedied by means of these actions and what benefits have been seen as a result of the actions taken.

Q.40 Councillor Claire Byrne

To ask the Area Manager for an update on the plans for the pram sheds and bin storage solutions for Vincent Street South flats in Dublin 8.

Q.41 Councillor Claire Byrne

To ask the Area Manager why the minutes of meetings that take place with council officials, councillors and local residents in relation to local issues in the South East Area are not circulated after such meetings, and if this practice can be implemented going forward.

Q.42 Councillor Claire Byrne

To ask the Area Manager if she is aware of any proposals regarding Airbnb in the City in areas not zoned for commercial activity, if there are plans to introduce to requests for registrations of rentals and requests for change of use when sub letting properties through Airbnb, and if she can outline what the complaints procedure is for people living in apartment complexes experiencing difficulties with neighbours sub - letting their apartments through Airbnb.

Q.43 Councillor Claire Byrne

To ask the Area Manager if she is aware that some casual traders on the Liffey Campshires who previously received electricity from the Dublin Docklands Authority are now finding difficulty in receiving electricity from Dublin City Council and can she please take steps to ensure that the supply is restored as a matter of urgency.

Q.44 Councillor Claire Byrne

To ask the Area Manager if she could provide further details on the proposed Cultural Hub in Pigeon House Precinct as referenced in the draft Poolbeg West SDZ.

Q.45 Councillor Patrick Costello

To ask the manager to put a stop sign on where Harrisons Avenue joins Rathgar Avenue as currently cars trying to avoid traffic will sit blocking the footpath for pedestrians.

Q.46 Councillor Patrick Costello

To ask the manager to fix the two broken street lights on Rathgar Avenue.

Q.47 Councillor Patrick Costello

To ask the manager to repaint the double yellow lines on the lane behind Garville Avenue that were not replaced following repairs to the road.

Q.48 Councillor Patrick Costello

To ask the manager to relocate the disabled car parking space from Highfield Road to the village centre in Rathgar.

Q.50 Councillor Patrick Costello

To ask the manager what discussions have taken place between the developers and the Parks Division re the public park area within Marianella?

